

# 409-Q

version 2

by Associated Marketing Concepts  
 21624 Marilla Street, Chatsworth, CA 91311-4123  
 (800) 270-4262 | (818) 678-1651 | FAX (818) 678-1655  
 www.ambassador-amc.com

**Ambassador**  
 FINE FAUCETS

Model #	<b>409-Q v2</b>		
Series	Cleopatra		
Type	Bidet		
Main Finish	Chrome	Accent Finish	None
Valve	Ceramic Disk		
By	SS	Modified/Approved	5-12-04
Fulfillment	FWBA5203CP		

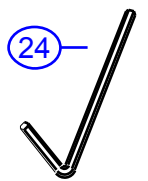
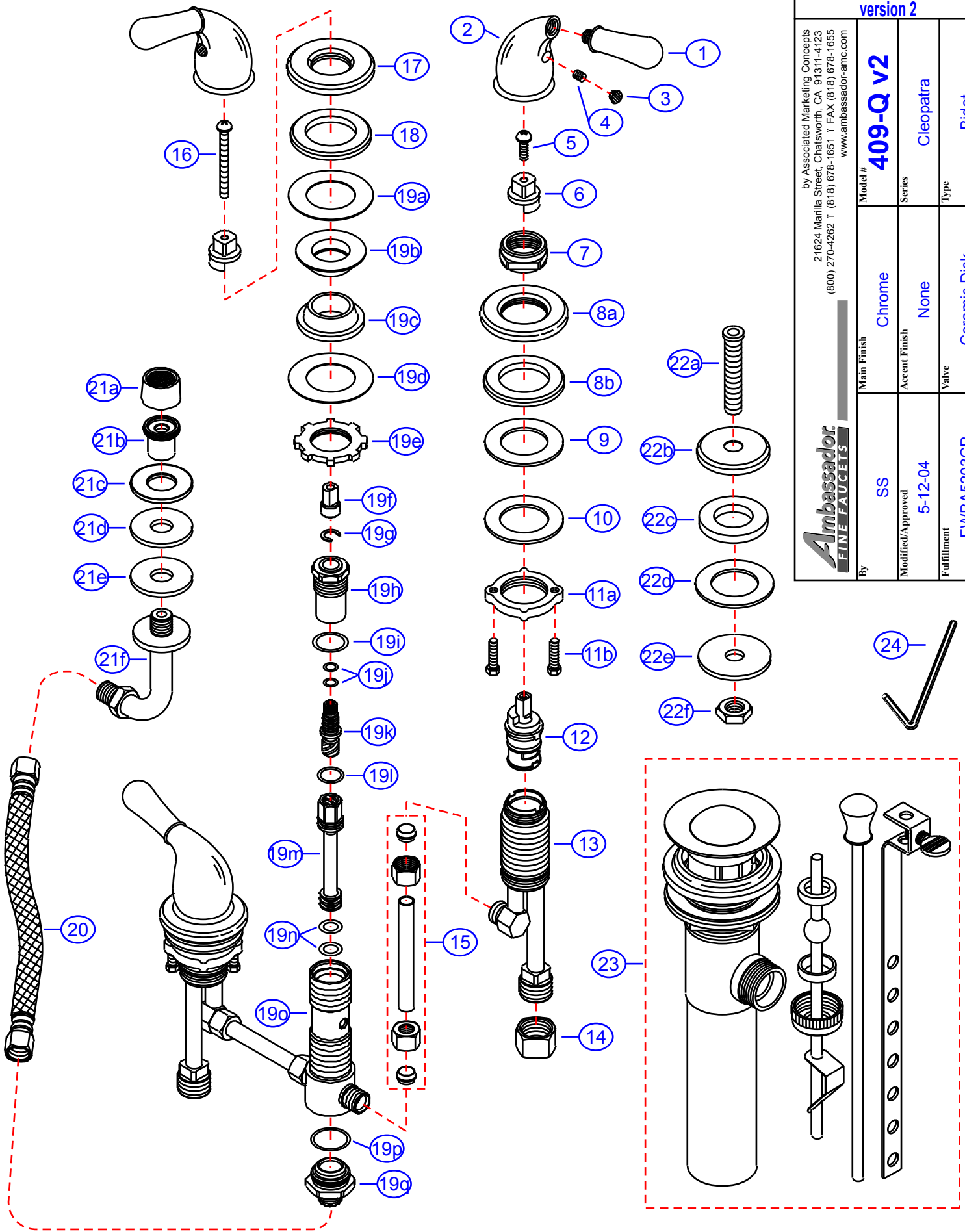

# 409-Q v2



## Cleopatra Bidet- CD/CP

#	Description	Quantity	Part #	Finish
1	Handle Tip	3	E-108041CP	Chrome
2	Handle Canopy	3	E-018052CP	Chrome
3	Red Plug	1	E-028046H	Rubber
	Blue Plug	1	E-028046C	Rubber
	Black Plug	1	E-028046M	Rubber
4	Set Screw	3	E-008003	Metal
5	Screw	2	E-008044CP	Chrome
6	Adapter (Hot)	2	E-110114H	Plastic
	Adapter (Cold)	1	E-110114C	Plastic
7	Retainer Nut	2	E-016002CP	Chrome
8	Escutcheon (Assembled)	2	EA-663201CP	Chrome
8a	Escutcheon	2	E-204000CP*	Chrome
8b	Gasket	2	E-010020	Rubber
9	Rubber Washer	2	E-010017	Rubber
10	Metal Washer	2	E-013018NI	Metal
11	Lock Nut w/Screws	2	EA-663066	Brass/Metal
11a	Lock Nut	2	E-009012	Brass
11b	Screw	4	E-008045	Metal
12	Cartridge (Hot)	1	E-507003NH	Ceramic Disc
	Cartridge (Cold)	1	E-507003NC	Ceramic Disc
13	Valve Body	2	E-044183	Brass
14	Connector Nuts	2	E-009016	Brass
15	Connector	2	E-504104	Brass
16	Diverter Handle Screw	1	E-008037CP	Chrome
17	Diverter Escutcheon	1	E-204012CP	Chrome
18	Gasket	1	E-010020	Rubber
19	Diverter Valve (Assembled)	1	G-X2111	Brass
19a	Metal Washer	1	E-013068	Metal
19b	Gasket	1	E-101019	Rubber
19c	Gasket	1	E-101020	Rubber
19d	Metal Washer	1	E-013068	Metal
19e	Metal Spider Washer	1	E-009082NI	Metal
19f	Adapter	1	E-110031*	Brass
19g	"C" Clip	1	E-012014*	Metal
19h	Adapter Body	1	E-034023*	Brass
19i	O-Ring	1	E-004074*	Rubber
19j	O-Ring	2	E-048089*	Rubber
19k	Stem	1	E-017065*	Brass
19l	O-Ring	1	E-048081*	Rubber
19m	Plunger	1	E-024034*	Brass
19n	O-Ring	2	E-004011*	Rubber
19o	Diverter Valve Body	1	E-044073*	Brass
19p	O-Ring	1	E-013072*	Rubber
19q	Hose Port	1	E-057047*	Brass
20	Hose	1	E-105021	Hose
21	Spout (Assembled)	1	G-X2112CP	Chrome
21a	Aerator	1	E-500032CP	Chrome
21b	Aerator Connector	1	E-039048CP*	Chrome
21c	Escutcheon	1	E-013070CP*	Chrome
21d	Rubber Washer	1	E-010074*	Rubber
21e	Rubber Washer	1	E-010074*	Rubber
21f	Spout	1	E-518022*	Brass
22	Lift Rod Holder (Assembled)	1	EA-504081CP	Chrome
22a	Sleeve	1	E-017033CP*	Chrome
22b	Escutcheon	1	E-045004CP*	Chrome
22c	Gasket	1	E-010097*	Rubber
22d	Rubber Washer	1	E-010017*	Rubber
22e	Metal Washer	1	E-013071ZN*	Metal
22f	Nut	1	E-009010*	Brass
23	Drain Kit (see "Drains" for parts)	1	EA-505039CP	Chrome
24	Allen Key	1	E-031000	Metal

\* Grayed parts are not available individually. "Assembled" item required.