

Rev. Change

A	Original
B	
C	
D	

# 132-1514-xx

SHURflo Marine Grade Faucets  
 5900 Katella Ave., Cypress, CA 90630  
 800.854.3218 • 562.795.5200 • Fax 562.795.7564  
 www.shurflo.com



Rev #	A	Package Style	OEM	Model #	<b>132-1514-xx</b>
Vendor #				Series	S Handle
Drawn By	SS	Approved/Modified	12/30/05	Type	4" Mini-Spread Faucet

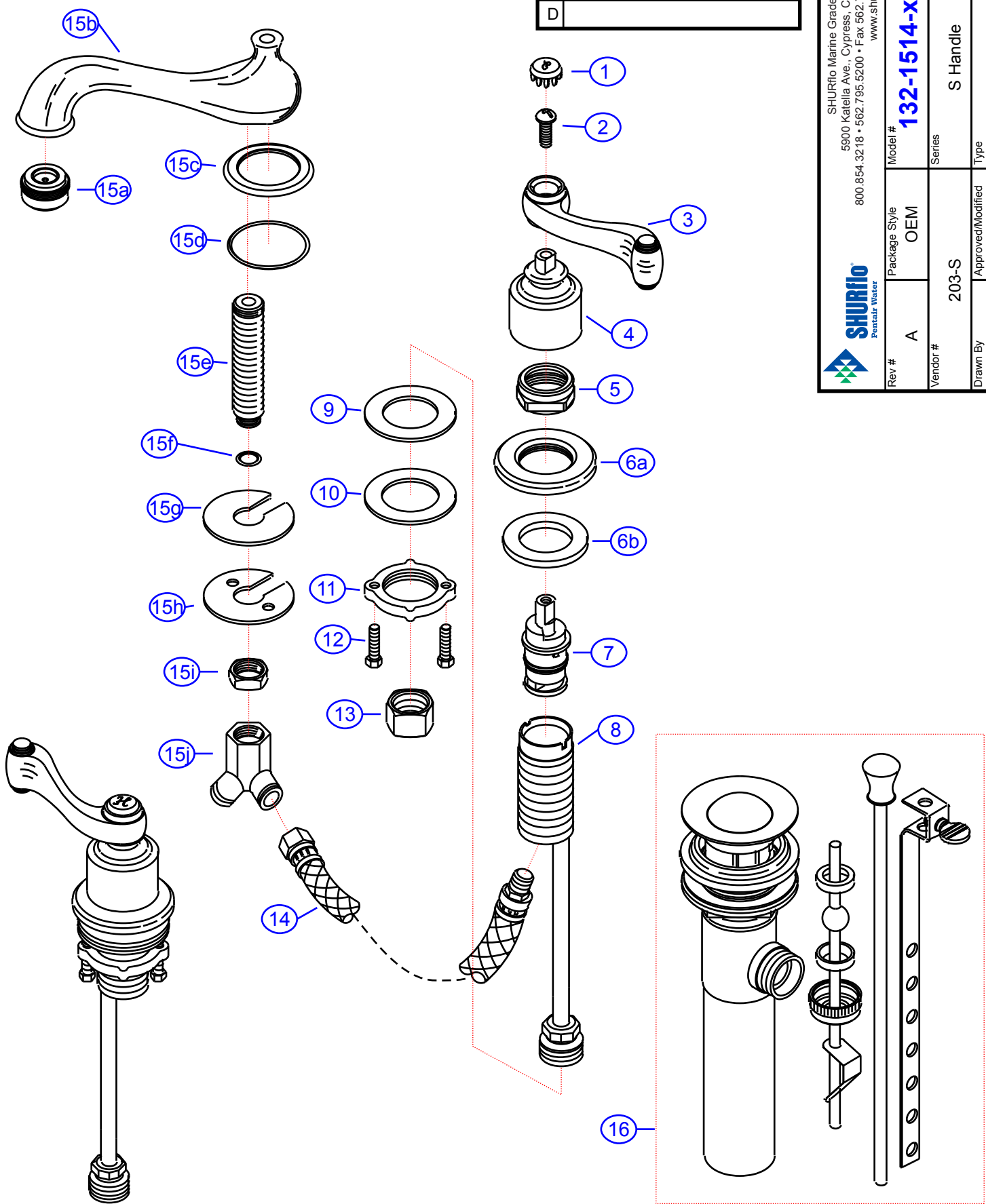

NOT DRAWN TO SCALE

132-1514-xx

S Handle  
 4" Mini-Spread Faucet  
 Rev. A



#	Description	Part #	Finish						Qty
			CP						
1	Cap "H"	E-206041H	CP						1
	Cap "C"	E-206041C	CP						1
2	Screw	E-008044	CP						2
3	"S" Handle (Hot)	E-108036H	CP						1
	"S" Handle (Cold)	E-108036C	CP						1
4	Canopy (Hot)	E-018154H	CP						1
	Canopy (Cold)	E-018154C	CP						1
5	Retainer Nut	E-016002	CP						2
6	Escutcheon Assembly	EA-663201	CP						2
6a	Escutcheon	E-204000*	CP						2
6b	Escutcheon Washer	E-010020							2
7	Cartridge (Hot)	E-507003NH							1
	Cartridge (Cold)	E-507003NC							1
8	Valve Body	E-002027N							2
9	Rubber Washer	E-010017							2
10	Metal Washer	E-013018NI							2
11	Lock Nut	E-009012							2
12	Screws	E-008045							4
13	Connector Nuts	E-009016							2
14	Hose	E-105007N							2
15	Spout Assembly	EA-666608	CP						1
15a	Aerator	E-500013N	CP						1
15b	Spout	E-100016N*	CP						1
15c	Spout Base	E-303001	CP						1
15d	O-Ring	E-048036							1
15e	Shank	E-014011N*							1
15f	O-Ring	E-004026							1
15g	Rubber Spout Washer	E-058094							1
15h	Metal Spout Washer	E-013006NI							1
15i	Spout Nut	E-009015							1
15j	"Y" Connector	E-015004N							1
16	Drain Assembly	EA-505039L	CP						1

\* - Part is not available individually. "Assembled" item is required.

\*\* - Assembly is in-stock at SHURflo and must be shipped directly from SHURflo's distribution center.

Prepared Exclusively For  
 SHURflo Marine Grade Faucets