

317-8000R

by Associated Marketing Concepts
 21624 Manilla Street, Chatsworth, CA 91311-4123
 (800) 270-4262 • (818) 678-1651 • FAX (818) 678-1655
 www.ambassador-amc.com

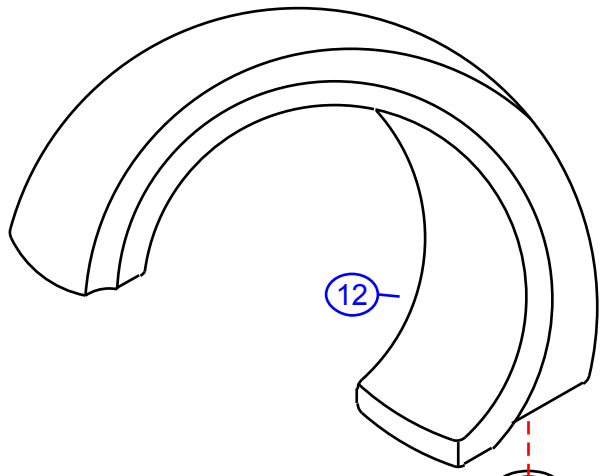

| | | | | | |
|-------------------|--------|---------------|--------------|---------|---------------------|
| By | SS | Main Finish | Chrome | Model # | 317-8000R |
| Modified/Approved | 5-2-06 | Accent Finish | 18k Gold | Series | Rope Ring |
| Fulfillment | xxxxCG | Valve | Ceramic Disk | Type | Roman/Whirlpool Tub |



12

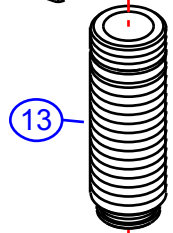

13

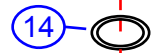

14

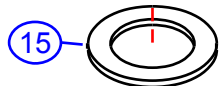

15

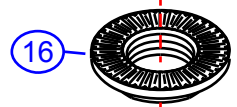

16

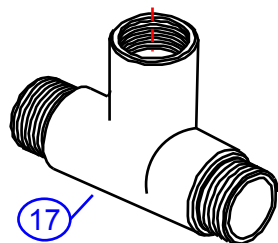

17

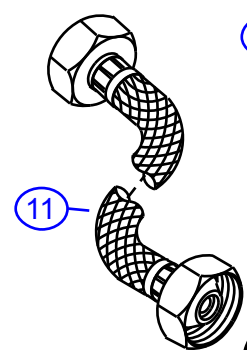
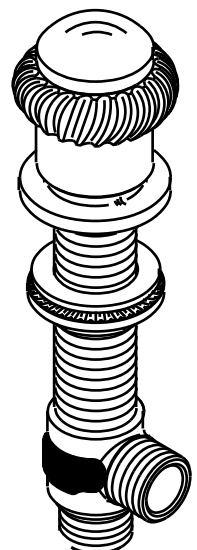

11

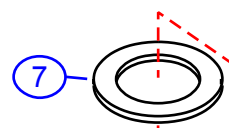

7

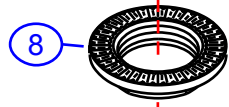

8

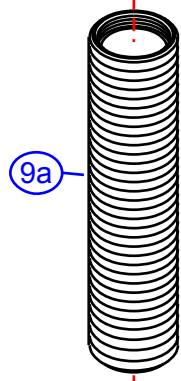

9a



9b

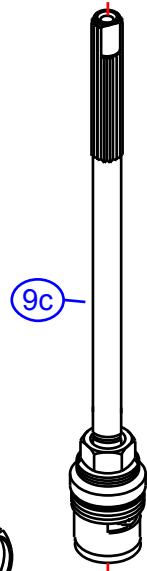

9c



9d

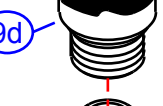

9e

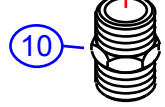

10

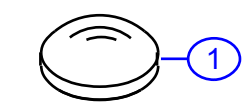

1

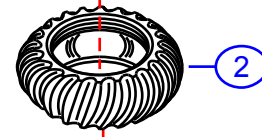

2

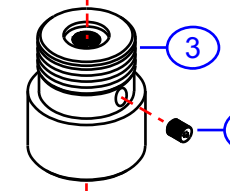

3



4

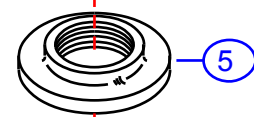

5

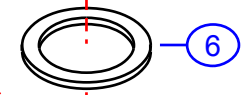

6

317-8000R



Rope Ring Roman/Whirlpool Tub- CD/CG

| # | Description | Quantity | Part # | Finish |
|----|----------------------------|----------|------------|--------------|
| 1 | Cap | 2 | E-206082CP | Chrome |
| 2 | Trim Ring | 2 | E-218022GP | Gold |
| 3 | Canopy | 2 | G-xxxxCP | Chrome |
| 4 | Set Screw | 2 | G-xxxx | Metal |
| 5 | Escutcheon | 2 | G-xxxxGP | Gold |
| 6 | Rubber Washer | 2 | G-xxxx | Rubber |
| 7 | Rubber Washer | 2 | G-xxxx | Rubber |
| 8 | Lock Nut | 2 | G-xxxx | Brass |
| 9 | Valve Body (Assembled) Hot | 2 | G-Axxxx | Brass |
| 9a | Body | 2 | E-014040* | Brass |
| 9b | "C" Clip | 2 | E-012019* | Metal |
| 9c | Cartridge (Hot) | 2 | E-507060H* | Ceramic Disc |
| 9d | Valve Bottom | 2 | E-061003* | Brass |
| 9e | Clip (Red) | 2 | E-012024H* | Plastic |
| 10 | Reducer | 2 | E-035002 | Brass |
| 11 | Hose | 2 | E-105011 | Hose |
| 12 | Spout | 1 | E-100039CP | Chrome |
| 13 | Spout Shaft | 1 | E-014006 | Brass |
| 14 | O-Ring | 1 | E-004010N | Rubber |
| 15 | Rubber Washer | 1 | E-010023 | Rubber |
| 16 | Lock Nut | 1 | E-054027 | Brass |
| 17 | "T" Connector | 1 | E-015007 | Brass |

* Grayed parts are not available individually. "Assembled" item required.

by Associated Marketing Concepts
21624 Marilla Street, Chatsworth, CA 91311-4123
(800) 270-4262 * (818) 678-1651 * FAX (818) 678-1655
www.ambassador-amc.com