

35-F

by Associated Marketing Concepts
21624 Marilla Street, Chatsworth, CA 91311-4123
(800) 270-4262 | (818) 678-1651 | FAX (818) 678-1655
www.ambassador-amc.com

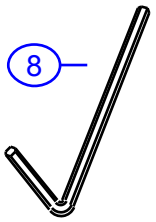

By	SS	Main Finish	Brushed Nickel	Model #	35-F
Modified/Approved	4-28-04	Accent Finish	Chrome	Series	Bar-Lever
Fulfillment	B5241000NC	Valve	NA	Type	Robe Hook

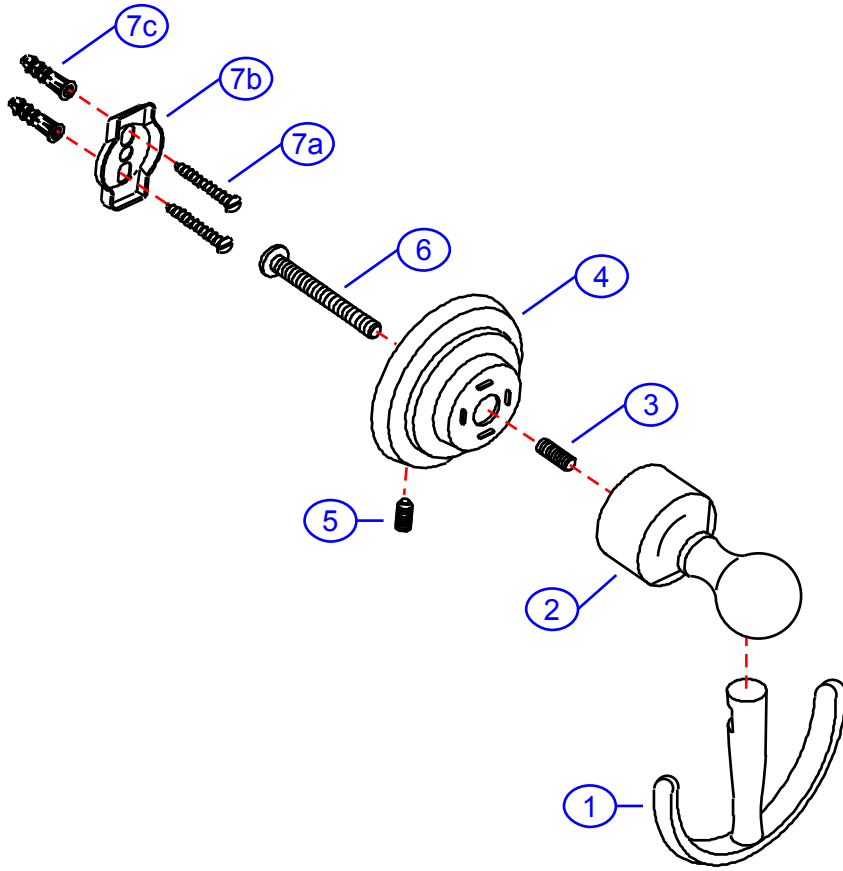

35-F



Bar-Lever Robe Hook- NC

#	Description	Quantity	Part #	Finish
1	Hook	1	E-253021NP*	Brushed Nickel
2	Body	1	E-240062NP*	Brushed Nickel
3	Set Screw	1	E-065033*	Metal
4	Base	1	E-241041CP*	Chrome
5	Set Screw	1	E-075039	Metal
6	Post Screw	1	E-292516ZN*	Metal
7	Mounting Hardware	1	EA-290013	Metal
7a	Mounting Screw	2	E-053022*	Metal
7b	Wall Plate	1	E-293003*	Metal
7c	Screw Mollies	2	E-291001*	Plastic
8	Allen Key	1	E-031000	Metal

* Grayed parts are not available individually. "Assembled" item required.

by Associated Marketing Concepts
21624 Marilla Street, Chatsworth, CA 91311-4123
(800) 270-4262 * (818) 678-1651 * FAX (818) 678-1655
www.ambassador-amc.com