

16-G

by Associated Marketing Concepts
 21624 Marilla Street, Chatsworth, CA 91311-4123
 (800) 270-4262 | (818) 678-1651 | FAX (818) 678-1655
 www.ambassador-amc.com

| | | | | | |
|-------------------|--------|---------------|-----------------------|---------|-------------|
| By | SS | Main Finish | 18k Gold | Model # | 16-G |
| Modified/Approved | 5-3-04 | Accent Finish | Gray Marble / Acrylic | Series | Gray Marble |
| Fulfillment | xxxxGW | Valve | NA | Type | Soap Dish |

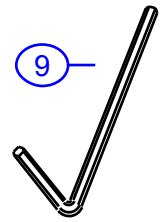
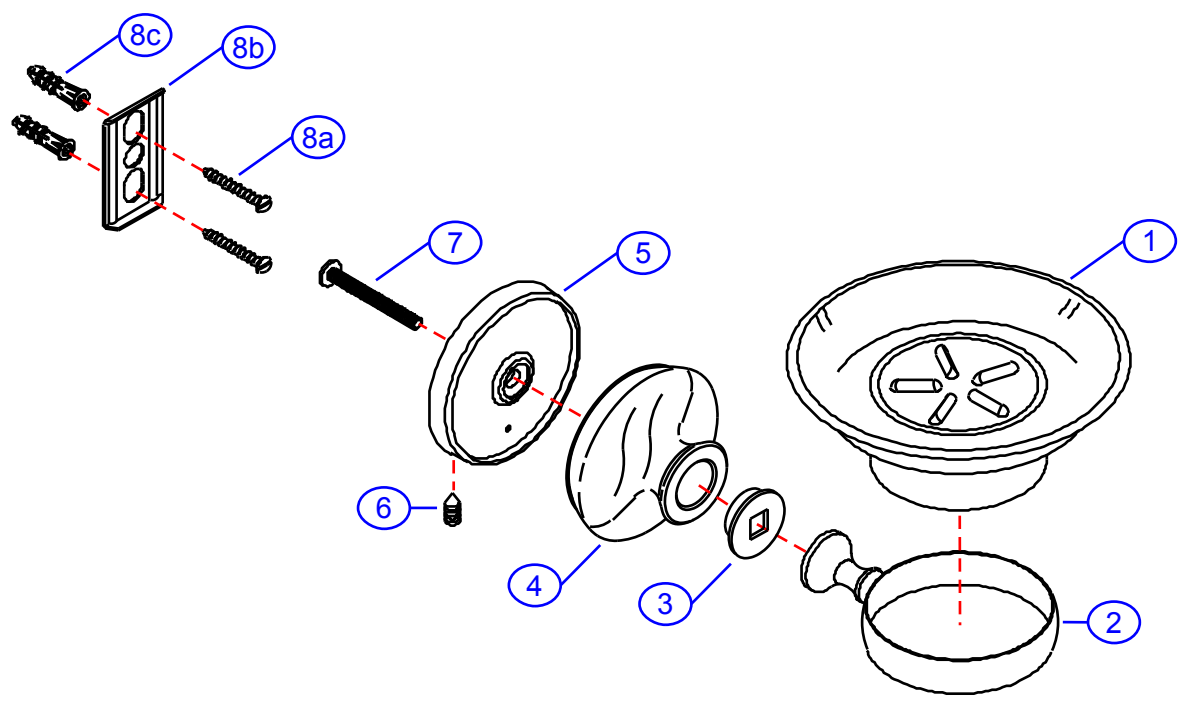

16-G



Marble Soap Holder- GP

| # | Description | Quantity | Part # | Finish |
|----|-------------------|----------|-------------|---------------|
| 1 | Dish (Plastic) | 1 | E-265031 | Acrylic |
| 2 | Head Ring | 1 | E-244171GP* | Gold |
| 3 | Adapter | 1 | G-xxxxGP* | Gold |
| 4 | Body | 1 | E-018023* | Marble |
| 5 | Base | 1 | E-241011GP* | Gold |
| 6 | Set Screw | 1 | E-075039 | Metal |
| 7 | Post Screw | 1 | E-075088ZN* | Metal |
| 8 | Mounting Hardware | 1 | EA-290131 | Metal/Plastic |
| 8a | Mounting Screws | 2 | E-053022ZN* | Metal |
| 8b | Wall Plate | 1 | E-293000ZN* | Metal |
| 8c | Mollies | 2 | E-291001* | Plastic |
| 9 | Allen Key | 1 | E-031000 | Metal |

* Grayed parts are not available individually. "Assembled" item required.