

26-G

by Associated Marketing Concepts
 21624 Marilla Street, Chatsworth, CA 91311-4123
 (800) 270-4262 | (818) 678-1651 | FAX (818) 678-1655
 www.ambassador-amc.com

By	SS	Main Finish	Chrome	Model #	26-G
Modified/Approved	5-3-04	Accent Finish	Gray Marble / Acrylic	Series	Gray Marble
Fulfillment	xxxxCW	Valve	NA	Type	Soap Dish

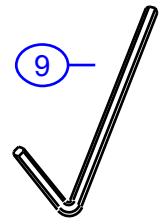
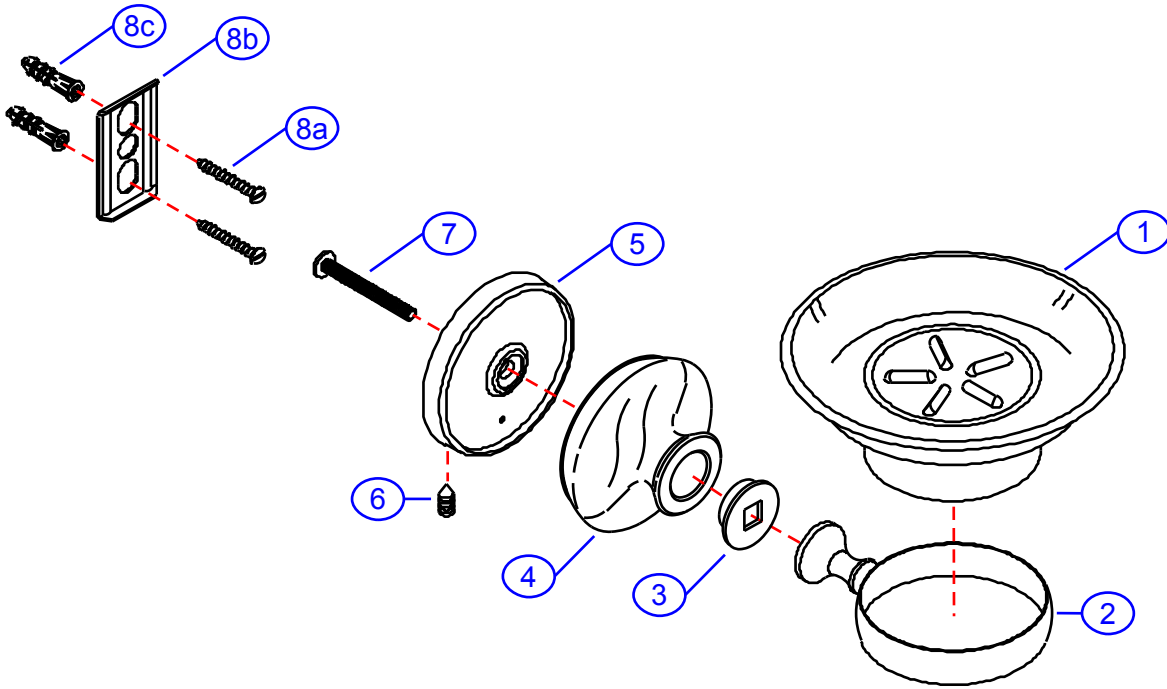

26-G



Marble Soap Holder- CP

#	Description	Quantity	Part #	Finish
1	Cup (Plastic)	1	E-265031	Acrylic
2	Head Ring	1	E-244171CP*	Chrome
3	Adapter	1	G-xxxxCP*	Chrome
4	Body	1	E-018023*	Marble
5	Base	1	E-241011CP*	Chrome
6	Set Screw	1	E-075039	Metal
7	Post Screw	1	E-075088ZN*	Metal
8	Mounting Hardware	1	EA-290131	Metal/Plastic
8a	Mounting Screws	2	E-053022ZN*	Metal
8b	Wall Plate	1	E-293000ZN*	Metal
8c	Mollies	2	E-291001*	Plastic
9	Allen Key	1	E-031000	Metal

* Grayed parts are not available individually. "Assembled" item required.