

# 26-SC

by Associated Marketing Concepts  
21624 Marilla Street, Chatsworth, CA 91311-4123  
(800) 270-4262 | (818) 678-1651 | FAX (818) 678-1655  
www.ambassador-amc.com

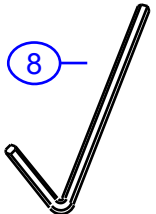

By	SS	Main Finish	Satin	Model #	26-SC
Modified/Approved	5-3-04	Accent Finish	Chrome / Acrylic	Series	Universal
Fulfillment	B5070200SC	Valve	NA	Type	Soap Dish

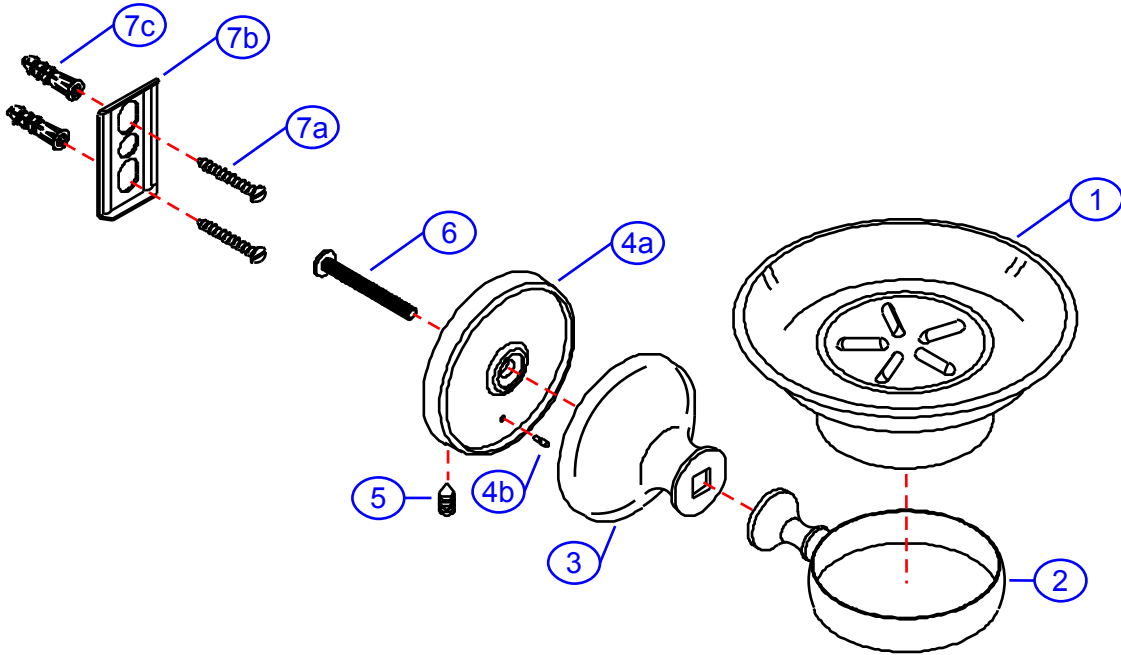

# 26-SC



## Universal Soap Holder- SC

#	Description	Quantity	Part #	Finish
1	Dish (Plastic)	1	E-265031	Acrylic
2	Head Ring	1	E-244171CP*	Chrome
3	Body	1	E-240001ST*	Satin
4	Base (Assembled)	1	EA-241311CP*	Chrome
4a	Base	1	E-241011CP*	Chrome
4b	Pin	1	E-255115*	Metal
5	Set Screw	1	E-075039	Metal
6	Post Screw	1	E-075088ZN*	Metal
7	Mounting Hardware	1	EA-290131	Metal/Plastic
7a	Mounting Screws	2	E-053022ZN*	Metal
7b	Wall Plate	1	E-293000ZN*	Metal
7c	Mollies	2	E-291001*	Plastic
8	Allen Key	1	E-031000	Metal

\* Grayed parts are not available individually. "Assembled" item required.