

36-V

by Associated Marketing Concepts
 21624 Marilla Street, Chatsworth, CA 91311-4123
 (800) 270-4262 | (818) 678-1651 | FAX (818) 678-1655
 www.ambassador-amc.com

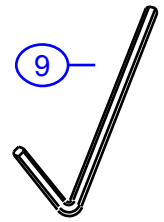

By	SS	Main Finish	Satin	Model #	36-V
Modified/Approved	5-3-04	Accent Finish	Chrome / Acrylic	Series	Bar-Lever
Fulfillment	B5271201SC	Valve	NA	Type	Soap Dish

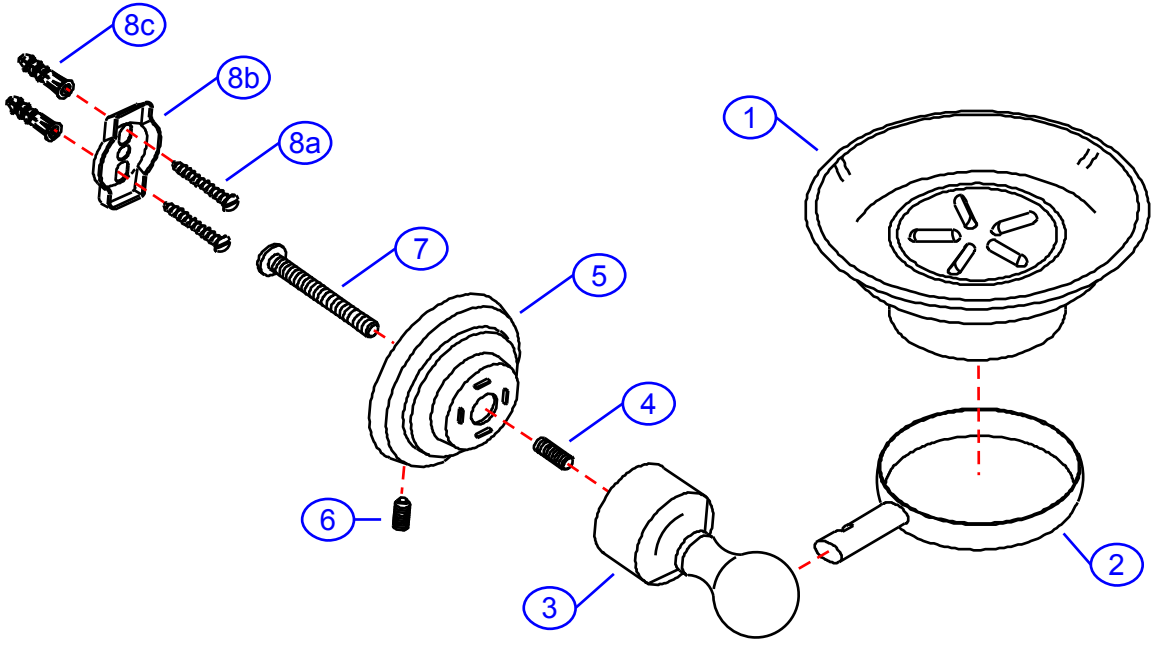

36-V



Bar-Lever Soap Holder- SC

#	Description	Quantity	Part #	Finish
1	Dish (Plastic)	1	E-265031	Acrylic
2	Head Ring	1	E-244042CP*	Chrome
3	Post Head	1	E-240062ST*	Satin
4	Set Screw	1	E-065033*	Metal
5	Base	1	E-241041CP*	Chrome
6	Set Screw	1	E-075039	Metal
7	Post Screw	1	E-292516ZN*	Metal
8	Mounting Hardware	1	EA-290013	Metal/Plastic
8a	Mounting Screws	2	E-053022*	Metal
8b	Wall Plate	1	E-293003*	Metal
8c	Mollies	2	E-291001*	Plastic
9	Allen Key	1	E-031000	Metal

* Grayed parts are not available individually. "Assembled" item required.