

23-B

by Associated Marketing Concepts
21624 Marilla Street, Chatsworth, CA 91311-4123
(800) 270-4262 | (818) 678-1651 | FAX (818) 678-1655
www.ambassador-amc.com

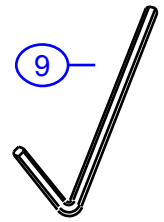

By	SS	Main Finish	Chrome	Model #	23-B
Modified/Approved	4-28-04	Accent Finish	18k Gold	Series	Universal
Fulfillment	B5050200CG	Valve	NA	Type	Towel Ring

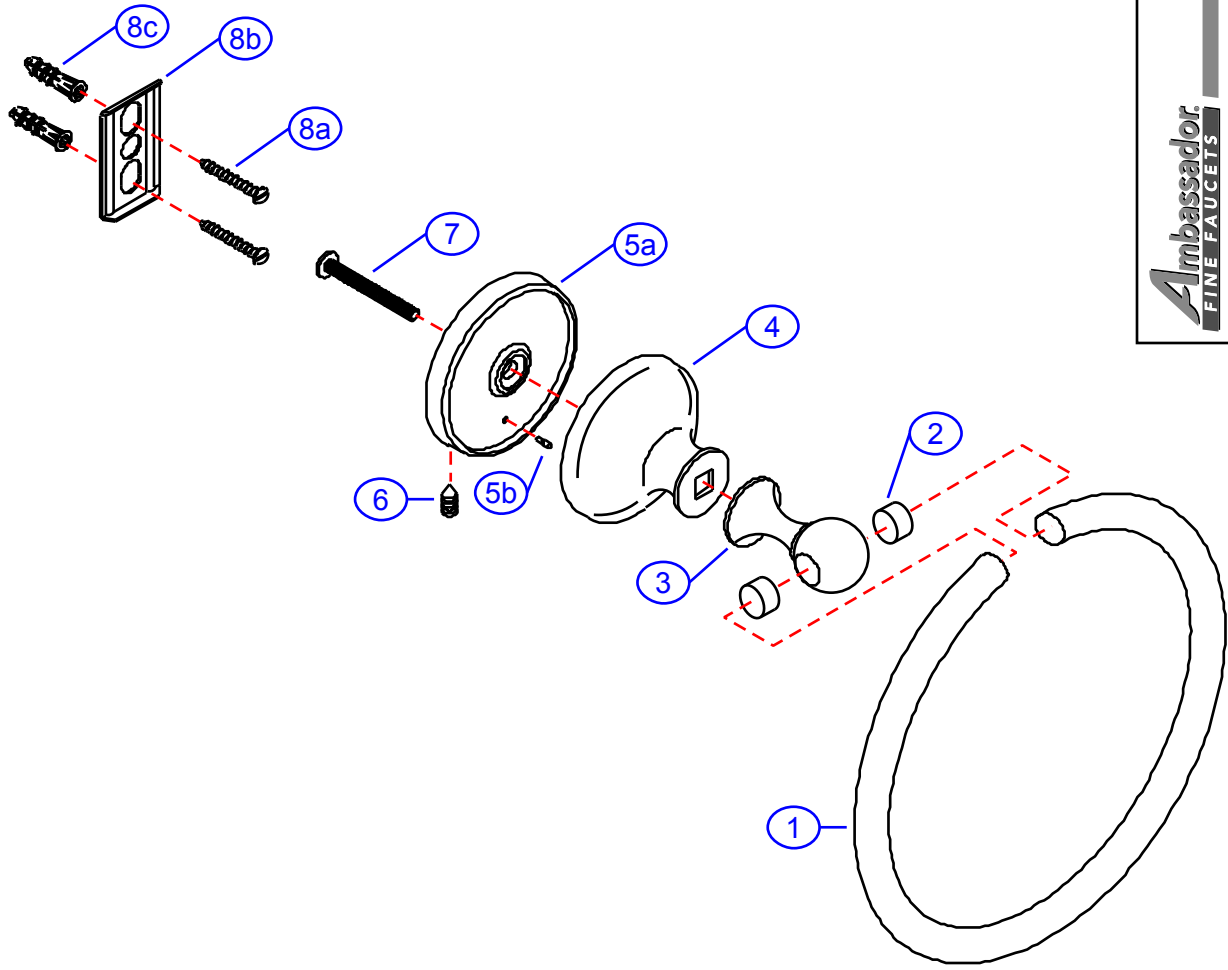

23-B



Universal Towel Ring- CG

#	Description	Quantity	Part #	Finish
1	Towel Ring	1	E-252001CP	Chrome
2	Towel Ring Plugs	2	E-255055	Plastic
3	Head	1	E-242001GP*	Gold
4	Body	1	E-240001CP*	Chrome
5	Base (Assembled)	1	EA-241311GP*	Gold
5a	Base	1	E-241011GP*	Gold
5b	Pin	1	E-255115*	Metal
6	Set Screw	1	E-075039	Metal
7	Post Screw	1	E-075093ZN*	Metal
8	Mounting Hardware	1	EA-290131	Metal
8a	Mounting Screw	2	E-053022ZN*	Metal
8b	Wall Plate	1	E-293000ZN*	Metal
8c	Screw Mollies	2	E-291001*	Plastic
9	Allen Key	1	E-031000	Metal

* Grayed parts are not available individually. "Assembled" item required.

by Associated Marketing Concepts
21624 Marilla Street, Chatsworth, CA 91311-4123
(800) 270-4262 * (818) 678-1651 * FAX (818) 678-1655
www.ambassador-amc.com