

23-SD

by Associated Marketing Concepts
21624 Marilla Street, Chatsworth, CA 91311-4123
(800) 270-4262 | (818) 678-1651 | FAX (818) 678-1655
www.ambassador-amc.com

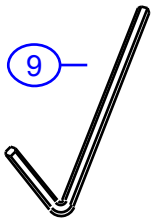

| | | | | | |
|-------------------|------------|---------------|------------------|---------|------------|
| By | SS | Main Finish | Satin | Model # | 23-SD |
| Modified/Approved | 4-28-04 | Accent Finish | Dura-Life Finish | Series | Universal |
| Fulfillment | B5050200SY | Valve | NA | Type | Towel Ring |

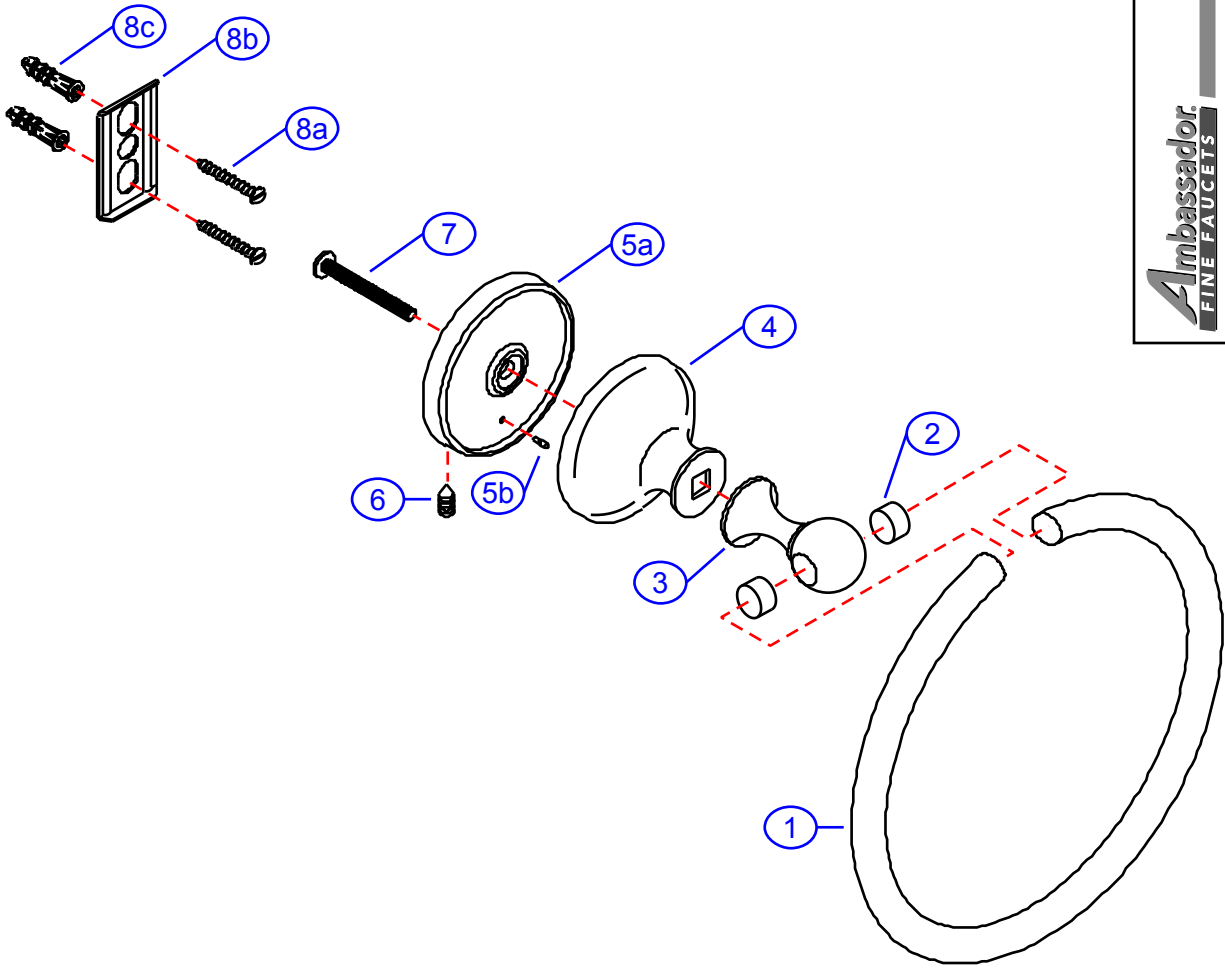

23-SD



Universal Towel Ring- SD

| # | Description | Quantity | Part # | Finish |
|----|-------------------|----------|--------------|------------------|
| 1 | Towel Ring | 1 | E-252001ST | Satin |
| 2 | Towel Ring Plugs | 2 | E-255055 | Plastic |
| 3 | Head | 1 | E-242001YP* | Dura-Life Finish |
| 4 | Body | 1 | E-240001ST* | Satin |
| 5 | Base (Assembled) | 1 | EA-241311YP* | Dura-Life Finish |
| 5a | Base | 1 | E-241011YP* | Dura-Life Finish |
| 5b | Pin | 1 | E-255115* | Metal |
| 6 | Set Screw | 1 | E-075039 | Metal |
| 7 | Post Screw | 1 | E-075093ZN* | Metal |
| 8 | Mounting Hardware | 1 | EA-290131 | Metal |
| 8a | Mounting Screw | 2 | E-053022ZN* | Metal |
| 8b | Wall Plate | 1 | E-293000ZN* | Metal |
| 8c | Screw Mollies | 2 | E-291001* | Plastic |
| 9 | Allen Key | 1 | E-031000 | Metal |

* Grayed parts are not available individually. "Assembled" item required.

by Associated Marketing Concepts
21624 Marilla Street, Chatsworth, CA 91311-4123
(800) 270-4262 * (818) 678-1651 * FAX (818) 678-1655
www.ambassador-amc.com