

33-V

by Associated Marketing Concepts
21624 Marilla Street, Chatsworth, CA 91311-4123
(800) 270-4262 | (818) 678-1651 | FAX (818) 678-1655
www.ambassador-amc.com

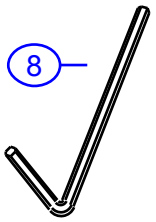

By	SS	Main Finish	Satin	Model #	33-V
Modified/Approved	4-28-04	Accent Finish	Chrome	Series	Bar-Lever
Fulfillment	B5251200SC	Valve	NA	Type	Towel Ring

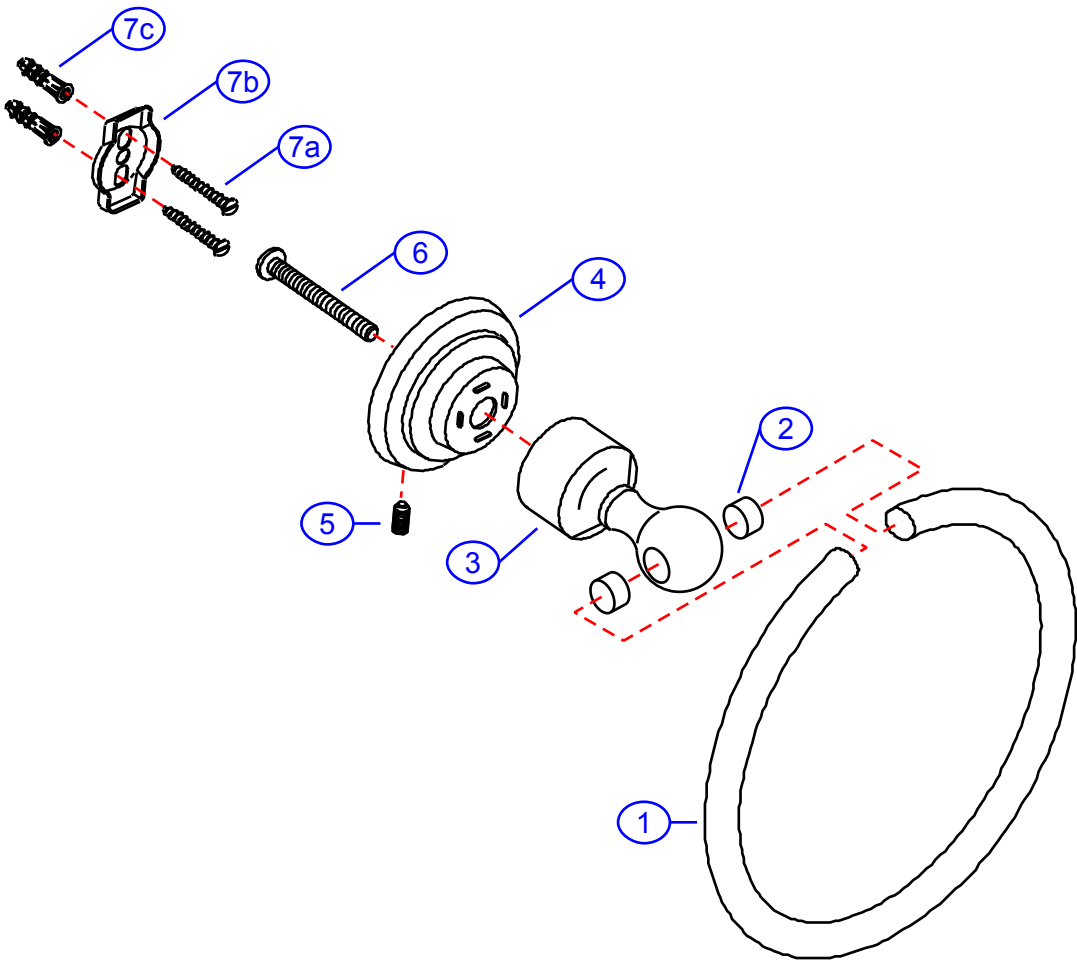

33-V



Bar-Lever Towel Ring- SC

#	Description	Quantity	Part #	Finish
1	Towel Ring	1	E-252282CP	Chrome
2	Towel Ring Plugs	2	E-255055	Plastic
3	Body	1	E-240102ST*	Satin
4	Base	1	E-241041CP*	Chrome
5	Set Screw	1	E-075039	Metal
6	Post Screw	1	E-292516ZN*	Metal
7	Mounting Hardware	1	EA-290013	Metal
7a	Mounting Screws	2	E-053022ZN*	Metal
7b	Wall Plate	1	E-293003ZN*	Metal
7c	Screw Mollies	2	E-291001*	Plastic
8	Allen Key	1	E-031000	Metal

* Grayed parts are not available individually. "Assembled" item required.

by Associated Marketing Concepts
21624 Marilla Street, Chatsworth, CA 91311-4123
(800) 270-4262 * (818) 678-1651 * FAX (818) 678-1655
www.ambassador-amc.com