

303-W

by Associated Marketing Concepts
 21624 Marilla Street, Chatsworth, CA 91311-4123
 (800) 270-4262 • (818) 678-1651 • FAX (818) 678-1655
 www.ambassador-amc.com

Ambassador
 FINE FAUCETS

By	SS	Main Finish	Satin	Model #	303-W
Modified/Approved	4-26-06	Accent Finish	None	Series	Bar-Lever
Fulfillment	FM0A5201ST	Valve	Ceramic Disk	Type	4" Mini-Spread Lav.

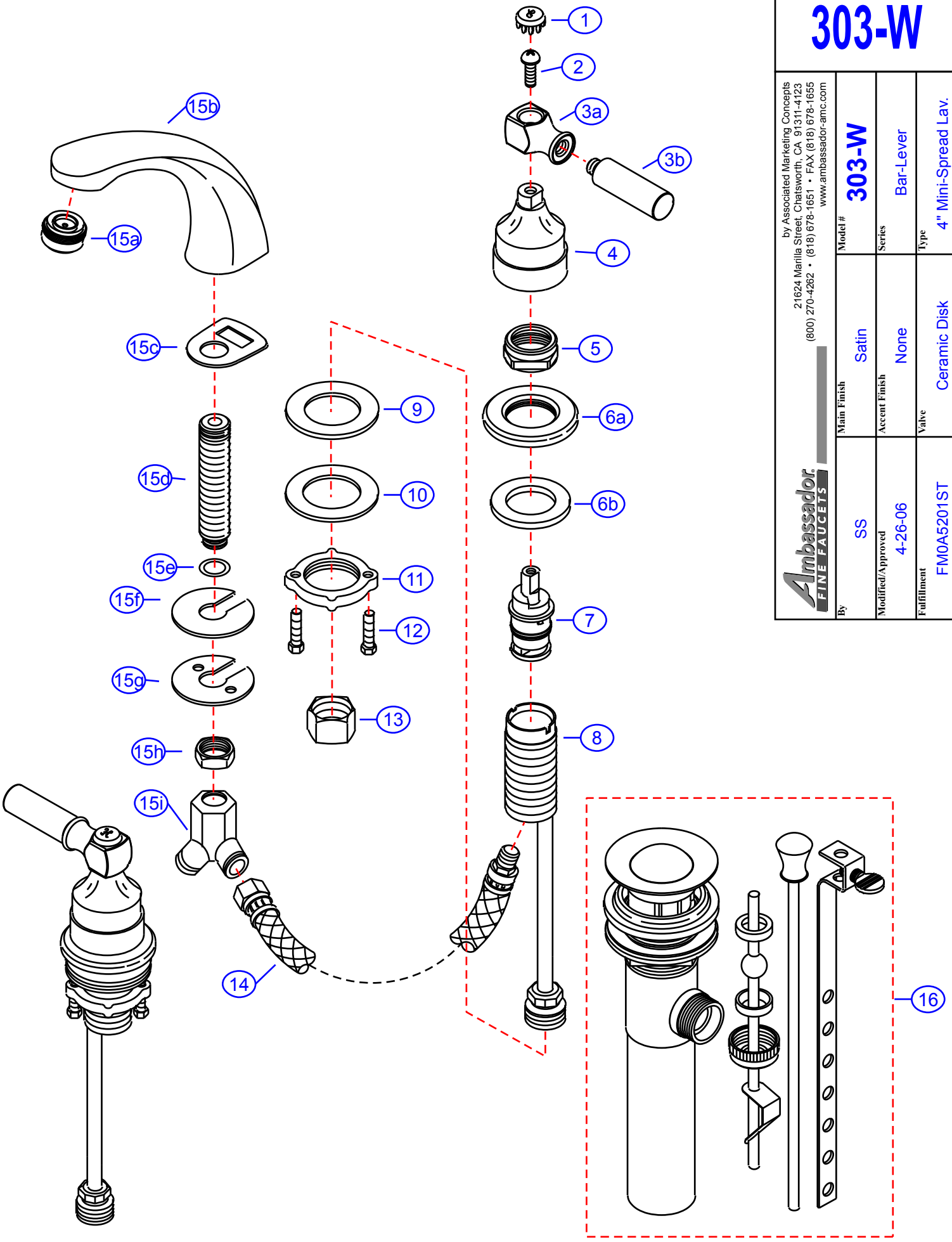

303-W



Bar-Lever 4" Mini-Spread Lav- CD/ST

#	Description	Quantity	Part #	Finish
1	Cap "H"	1	E-206041HST	Satin
	Cap "C"	1	E-206041CST	Satin
2	Handle Screw	2	E-008037CP	Metal
3	Handle	2	EA-662048ST	Satin
3a	Handle Head	2	E-107047ST*	Satin
3b	Handle Tip	2	E-552030ST*	Satin
4	Handle Canopy (Hot)	1	E-018027HST	Satin
	Handle Canopy (Cold)	1	E-018027CST	Satin
5	Retainer Nut	2	E-016002CP	Chrome
6	Escutcheon (Assembled)	2	EA-663201ST	Satin
6a	Escutcheon	2	E-204000ST*	Satin
6b	Gasket	2	E-010020	Rubber
7	Cartridge (Hot)	1	E-507003NH	Ceramic Disc
	Cartridge (Cold)	1	E-507003NC	Ceramic Disc
8	Valve Body	2	E-002027N	Brass
9	Rubber Washer	2	E-010017	Rubber
10	Metal Washer	2	E-013018NI	Metal
11	Lock Nut	2	E-009012	Brass
12	Screw	4	E-008045	Metal
13	Connector Nuts	2	E-009016	Brass
14	Hose	2	E-105007N	Hose
15	Spout (Assembled)	1	EA-666504ST	Satin
15a	Aerator	1	E-500013NST	Satin
15b	Spout	1	E-100047ST*	Satin
15c	Gasket	1	E-013021	Foam
15d	Shank	1	E-014011N*	Brass
15e	O-Ring	1	E-004026N	Rubber
15f	Rubber Spout Washer	1	E-058094	Rubber
15g	Metal Spout Washer	1	E-013006NI	Metal
15h	Spout Nut	1	E-009015	Brass
15i	"Y" Connector	1	E-015004N	Brass
16	Drain Kit (see "Drains" for parts)	1	EA-505039STL	Satin

* Grayed parts are not available individually. "Assembled" item required.

by Associated Marketing Concepts
 21624 Marilla Street, Chatsworth, CA 91311-4123
 (800) 270-4262 * (818) 678-1651 * FAX (818) 678-1655
www.ambassador-amc.com