

# 108-G

version 2

by Associated Marketing Concepts  
 21624 Marilla Street, Chatsworth, CA 91311-4123  
 (800) 270-4262 | (818) 678-1651 | FAX (818) 678-1655  
 www.ambassador-amc.com

**Ambassador**  
 FINE FAUCETS

By	SS	Main Finish	18k Gold	Model #	<b>108-G v2</b>
Modified/Approved	3-5-04	Accent Finish	Gray Marble	Series	Gray Marble
Fulfillment	xxxxGW	Valve	Ceramic Disk	Type	Roman/Whirlpool Tub

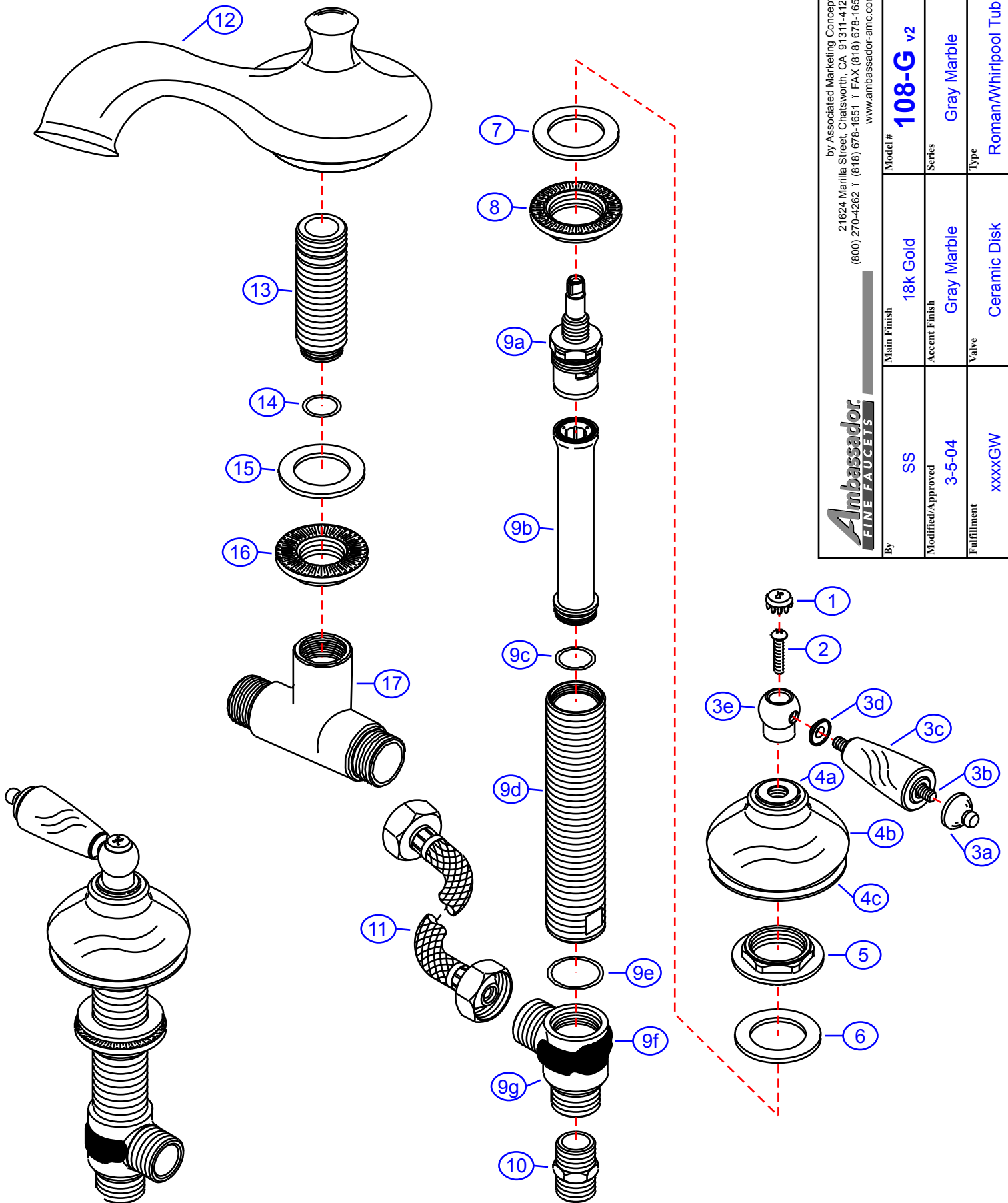

# 108-G v2



## Gray Marble Roman/Whirlpool Tub- CD/GP

#	Description	Quantity	Part #	Finish
1	Cap "H"	1	E-206041HGP	Gold
	Cap "C"	1	E-206041CGP	Gold
2	Handle Screw	2	E-008038CP	Chrome
3	Handle Marble	2	G-A90132GP	Gold/Marble
3a	Handle Tip	2	E-109003GP	Gold
3b	Handle Rod	2	E-017045	Metal
3c	Handle (Marble)	2	E-108027	Marble
3d	Handle Spacer	2	E-107034GP	Gold
3e	Handle Head	2	E-226002GP	Gold
4	Canopy (Assembled)	2	G-AxxxxGP	Gold/Marble
4a	Canopy Threads	2	E-205008GP*	Gold
4b	Canopy	2	E-018004*	Marble
4c	Canopy Base	2	E-215021GP*	Gold
5	Lock Nut	2	E-054026	Brass
6	Rubber Washer	2	E-010022	Rubber
7	Rubber Washer	2	E-010022	Rubber
8	Lock Nut	2	E-054026	Brass
9	Valve Body (Assembled) Hot	1	EA-550112H	Brass
	Valve Body (Assembled) Cold	1	EA-550112C	Brass
9a	Cartridge (Hot)	1	E-507055	Ceramic Disc
	Cartridge (Cold)	1	E-507056	Ceramic Disc
9b	Sleeve	2	E-035105*	Brass
9c	O-Ring	2	E-004074*	Rubber
9d	Body	2	E-014137*	Brass
9e	O-Ring	2	E-004081*	Rubber
9f	Clip (Red)	1	E-012024H*	Plastic
	Clip (Blue)	1	E-012024C*	Plastic
9g	Valve Bottom	2	E-055088*	Brass
10	Reducer	2	E-035002	Brass
11	Hose	2	E-105011	Hose
12	Spout	1	E-100041GP	Gold
13	Spout Shaft	1	E-014006	Brass
14	O-Ring	1	E-004010N	Rubber
15	Rubber Washer	1	E-010023	Rubber
16	Lock Nut	1	E-054027	Brass
17	"T" Connector	1	E-015007	Brass

\* Grayed parts are not available individually. "Assembled" item required.

by Associated Marketing Concepts  
 21624 Marilla Street, Chatsworth, CA 91311-4123  
 (800) 270-4262 \* (818) 678-1651 \* FAX (818) 678-1655  
 www.ambassador-amc.com