

# 108-X

version 3

by Associated Marketing Concepts  
 21624 Manilla Street, Chatsworth, CA 91311-4123  
 (800) 270-4262 | (818) 678-1651 | FAX (818) 678-1655  
 www.ambassador-amc.com

By	SS	Main Finish	18k Gold	Model #	<b>108-X v3</b>
Modified/Approved	3-8-04	Accent Finish	White Porcelain	Series	Cross Handle
Fulfillment	FR2BE000GW	Valve	Ceramic Disk	Type	Roman/Whirlpool Tub

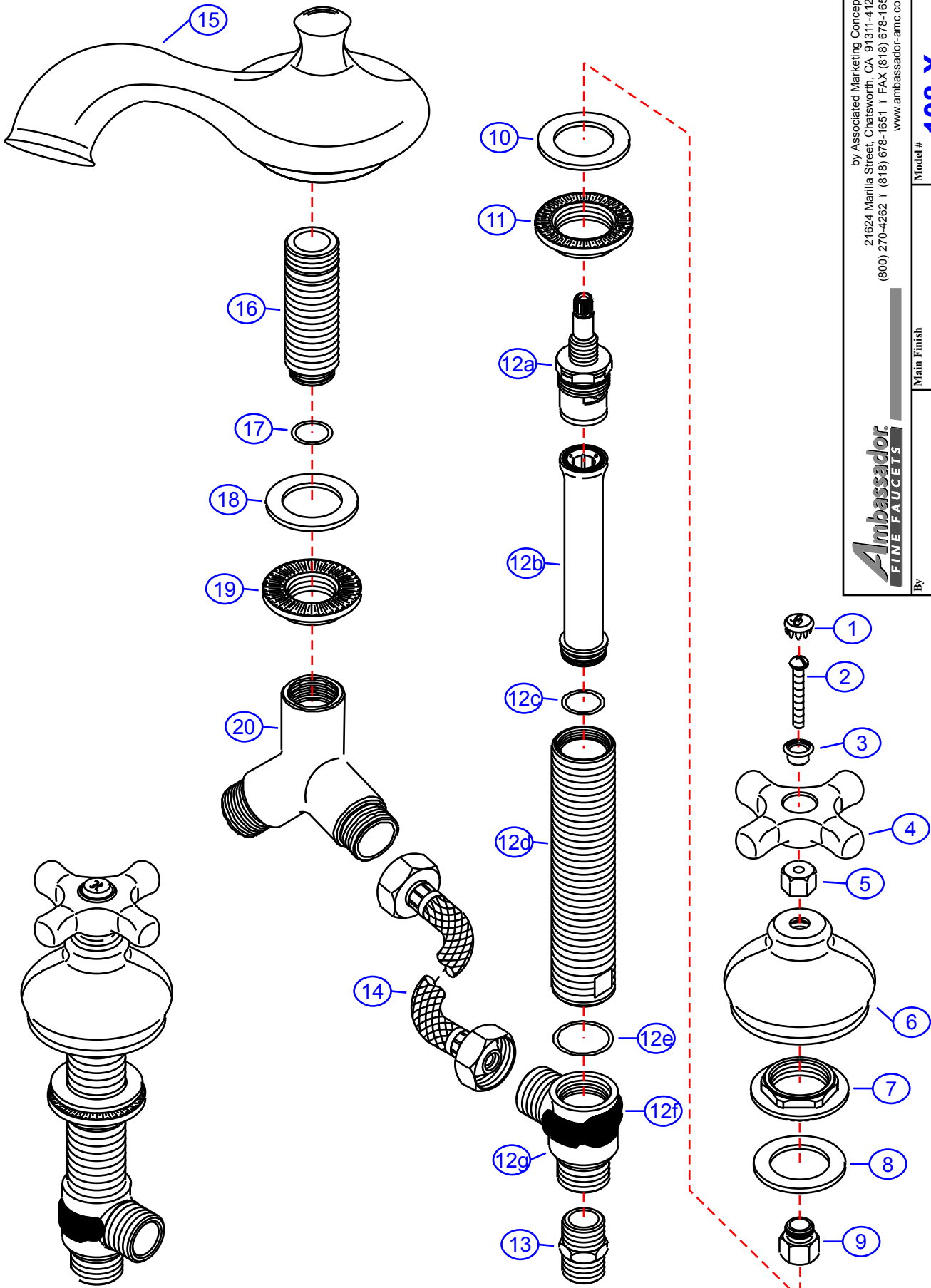

# 108-X v3



## Cross Handle Roman/Whirlpool Tub- CD/GP

#	Description	Quantity	Part #	Finish
1	Cap "H"	1	E-206041HGP	Gold
	Cap "C"	1	E-206041CGP	Gold
2	Handle Screw	2	E-008083CP	Chrome
3	Screw Housing	2	E-309000GP	Gold
4	Handle (Cross)	2	E-108025WH	Porcelain
5	Stem Adapter	2	E-230006	Brass
6	Canopy	2	E-018081GP	Gold
7	Lock Nut	2	E-054026	Brass
8	Rubber Washer	2	E-010022	Rubber
9	Adapter	2	E-057056	Brass
10	Rubber Washer	2	E-010022	Rubber
11	Lock Nut	2	E-054026	Brass
12	Valve Body (Assembled) Hot	1	EA-550112H	Brass
	Valve Body (Assembled) Cold	1	EA-550112C	Brass
12a	Cartridge (Hot)	1	E-507055	Ceramic Disc
	Cartridge (Cold)	1	E-507056	Ceramic Disc
12b	Sleeve	2	E-035105*	Brass
12c	O-Ring	2	E-004074*	Rubber
12d	Body	2	E-014137*	Brass
12e	O-Ring	2	E-004081*	Rubber
12f	Clip (Red)	1	E-012024H*	Plastic
	Clip (Blue)	1	E-012024C*	Plastic
12g	Valve Bottom	2	E-055088*	Brass
13	Reducer	2	E-035002	Brass
14	Hose	2	E-105011	Hose
15	Spout	1	E-100041GP	Gold
16	Spout Shaft	1	E-014006	Brass
17	O-Ring	1	E-004010N	Rubber
18	Rubber Washer	1	E-010023	Rubber
19	Lock Nut	1	E-054027	Brass
20	"Y" Connector	1	E-015007	Brass

\* Grayed parts are not available individually. "Assembled" item required.

by Associated Marketing Concepts  
 21624 Marilla Street, Chatsworth, CA 91311-4123  
 (800) 270-4262 \* (818) 678-1651 \* FAX (818) 678-1655  
[www.ambassador-amc.com](http://www.ambassador-amc.com)