

# 208-G

version 3

by Associated Marketing Concepts  
21624 Marilla Street, Chatsworth, CA 91311-4123  
(800) 270-4262 | (818) 678-1651 | FAX (818) 678-1655  
www.ambassador-amc.com

**Ambassador**  
FINE FACETS

By	SS	Chrome	Model #	<b>208-G v3</b>
Modified/Approved	2-5-04	Gray Marble	Series	Gray Marble
Fulfillment	FR2B7000CW	Ceramic Disk	Valve	Roman/Whirlpool Tub

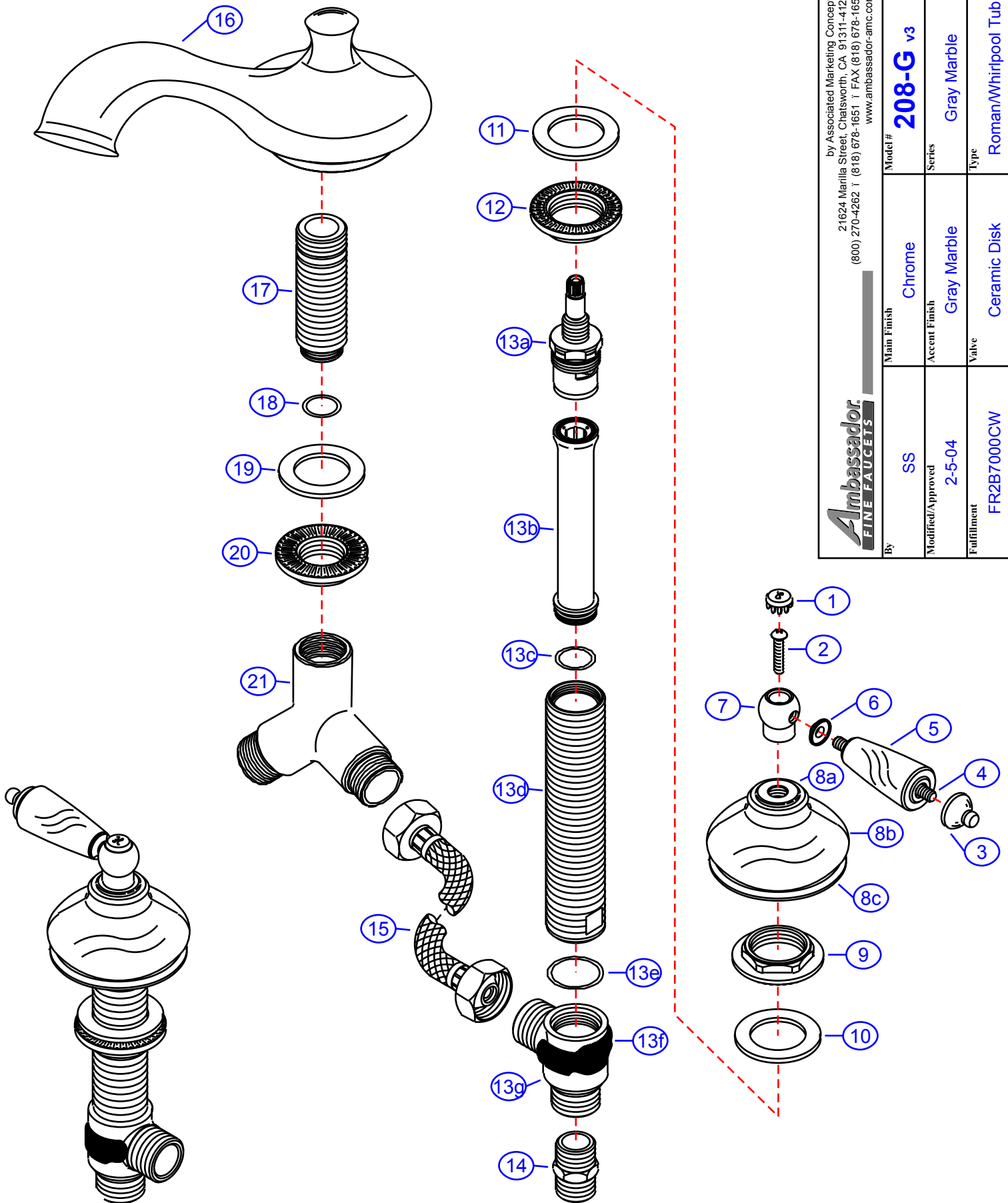

# 208-G v3



## Gray Marble Roman/Whirlpool Tub- CD/CP

#	Description	Quantity	Part #	Finish
1	Cap "H"	1	E-206041HCP	Chrome
	Cap "C"	1	E-206041CCP	Chrome
2	Handle Screw	2	E-008038CP	Chrome
3	Handle Tip	2	E-109003CP	Chrome
4	Handle Rod	2	E-017045	Metal
5	Handle (Marble)	2	E-108027	Marble
6	Handle Spacer	2	E-107034CP	Chrome
7	Handle Head	2	E-226011CP	Chrome
8	Canopy (Assembled)	2	G-X1111CP	Chrome/Marble
8a	Canopy Threads	2	E-205008CP*	Chrome
8b	Canopy	2	E-018004*	Marble
8c	Canopy Base	2	E-215021CP*	Chrome
9	Lock Nut	2	E-054026	Brass
10	Rubber Washer	2	E-010022	Rubber
11	Rubber Washer	2	E-010022	Rubber
12	Lock Nut	2	E-054026	Brass
13	Valve Body (Assembled) Hot	1	EA-550112H	Brass
	Valve Body (Assembled) Cold	1	EA-550112C	Brass
13a	Cartridge (Hot)	1	E-507055	Ceramic Disc
	Cartridge (Cold)	1	E-507056	Ceramic Disc
13b	Sleeve	2	E-035105*	Brass
13c	O-Ring	2	E-004074*	Rubber
13d	Body	2	E-014137*	Brass
13e	O-Ring	2	E-004081*	Rubber
13f	Clip (Red)	1	E-012024H*	Plastic
	Clip (Blue)	1	E-012024C*	Plastic
13g	Valve Bottom	2	E-055088*	Brass
14	Reducer	2	E-035002	Brass
15	Hose	2	E-105011	Hose
16	Spout	1	E-100041CP	Chrome
17	Spout Shaft	1	E-014006	Brass
18	O-Ring	1	E-004010N	Rubber
19	Rubber Washer	1	E-010023	Rubber
20	Lock Nut	1	E-054027	Brass
21	"Y" Connector	1	E-015007	Brass

\* Grayed parts are not available individually. "Assembled" item required.

by Associated Marketing Concepts  
 21624 Marilla Street, Chatsworth, CA 91311-4123  
 (800) 270-4262 \* (818) 678-1651 \* FAX (818) 678-1655  
[www.ambassador-amc.com](http://www.ambassador-amc.com)