

12

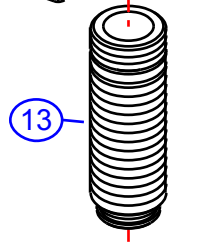

13

14

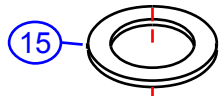

15

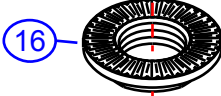

16

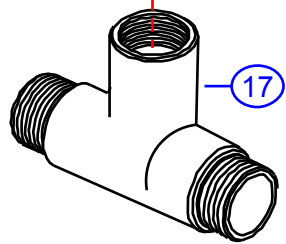

17

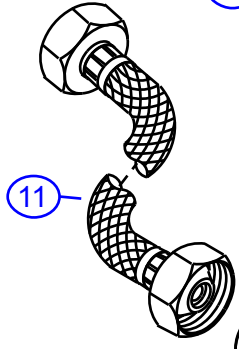
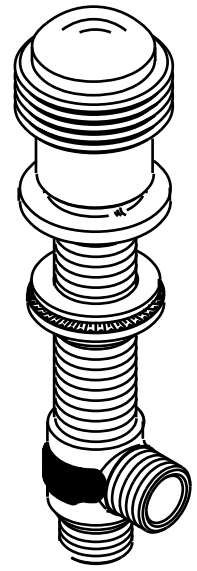

11

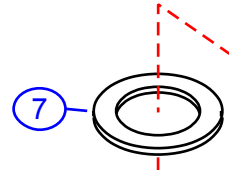

7

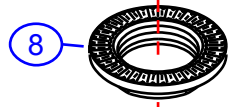

8

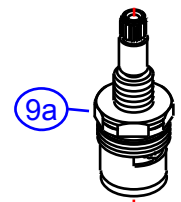

9a

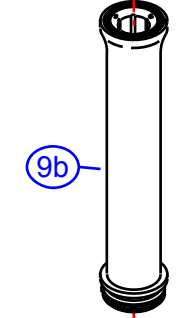

9b

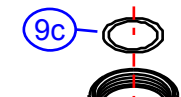

9c

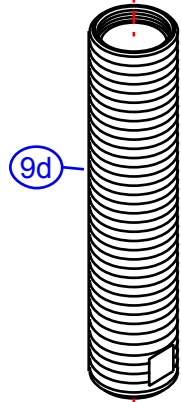

9d



9e



9f

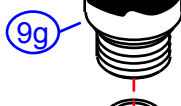

9g

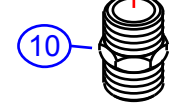

10

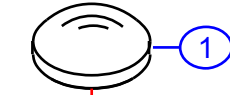

1



2

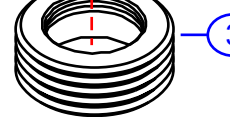

3

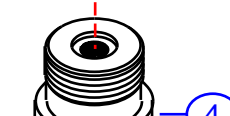

4

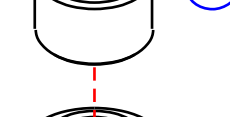

5

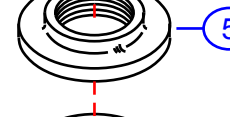

6

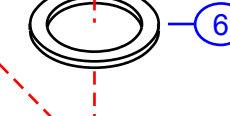

6

308-M

version 2

by Associated Marketing Concepts
 21624 Manilla Street, Chatsworth, CA 91311-4123
 (800) 270-4262 | (818) 678-1651 | FAX (818) 678-1655
 www.ambassador-amc.com

By	SS	Chrome	Model #	308-M v2
Modified/Approved	7-7-04	18k Gold	Series	Multi-Ring
Fulfillment	xxxxCG	Ceramic Disk	Valve	Roman/Whirlpool Tub

308-M v2



Multi-Ring Roman/Whirlpool Tub- CD/CG

#	Description	Quantity	Part #	Finish
1	Cap	2	E-206082CP	Chrome
2	Handle Screw	2	E-008013CP	Chrome
3	Trim Ring	2	E-218023GP	Gold
4	Canopy	2	E-215018CP	Chrome
5	Escutcheon	2	E-204015GP	Gold
6	Rubber Washer	2	E-010022	Rubber
7	Rubber Washer	2	E-010022	Rubber
8	Lock Nut	2	E-054026	Brass
9	Valve Body (Assembled) Hot	2	EA-550112H	Brass
9a	Cartridge (Hot)	2	E-507055	Ceramic Disc
9b	Sleeve	2	E-035105*	Brass
9c	O-Ring	2	E-004074*	Rubber
9d	Body	2	E-014137*	Brass
9e	O-Ring	2	E-004081*	Rubber
9f	Clip (Red)	2	E-012024H*	Plastic
9g	Valve Bottom	2	E-055088*	Brass
10	Reducer	2	E-035002	Brass
11	Hose	2	E-105011	Hose
12	Spout	1	E-100039CP	Chrome
13	Spout Shaft	1	E-014006	Brass
14	O-Ring	1	E-004010N	Rubber
15	Rubber Washer	1	E-010023	Rubber
16	Lock Nut	1	E-054027	Brass
17	"T" Connector	1	E-015007	Brass

* Grayed parts are not available individually. "Assembled" item required.

by Associated Marketing Concepts
 21624 Marilla Street, Chatsworth, CA 91311-4123
 (800) 270-4262 * (818) 678-1651 * FAX (818) 678-1655
www.ambassador-amc.com