

317-4000P

by Associated Marketing Concepts
 21624 Marilla Street, Chatsworth, CA 91311-4123
 (800) 270-4262 • (818) 678-1651 • FAX (818) 678-1655
 www.ambassador-amc.com

Ambassador
 FINE FAUCETS

By	SS	Main Finish	Chrome	Model #	317-4000P
Modified/Approved	5-1-06	Accent Finish	18k Gold	Series	Cleopatra
Fulfillment	xxxxCG	Valve	Standard (Washerless)	Type	2 Handle Shower/Tub

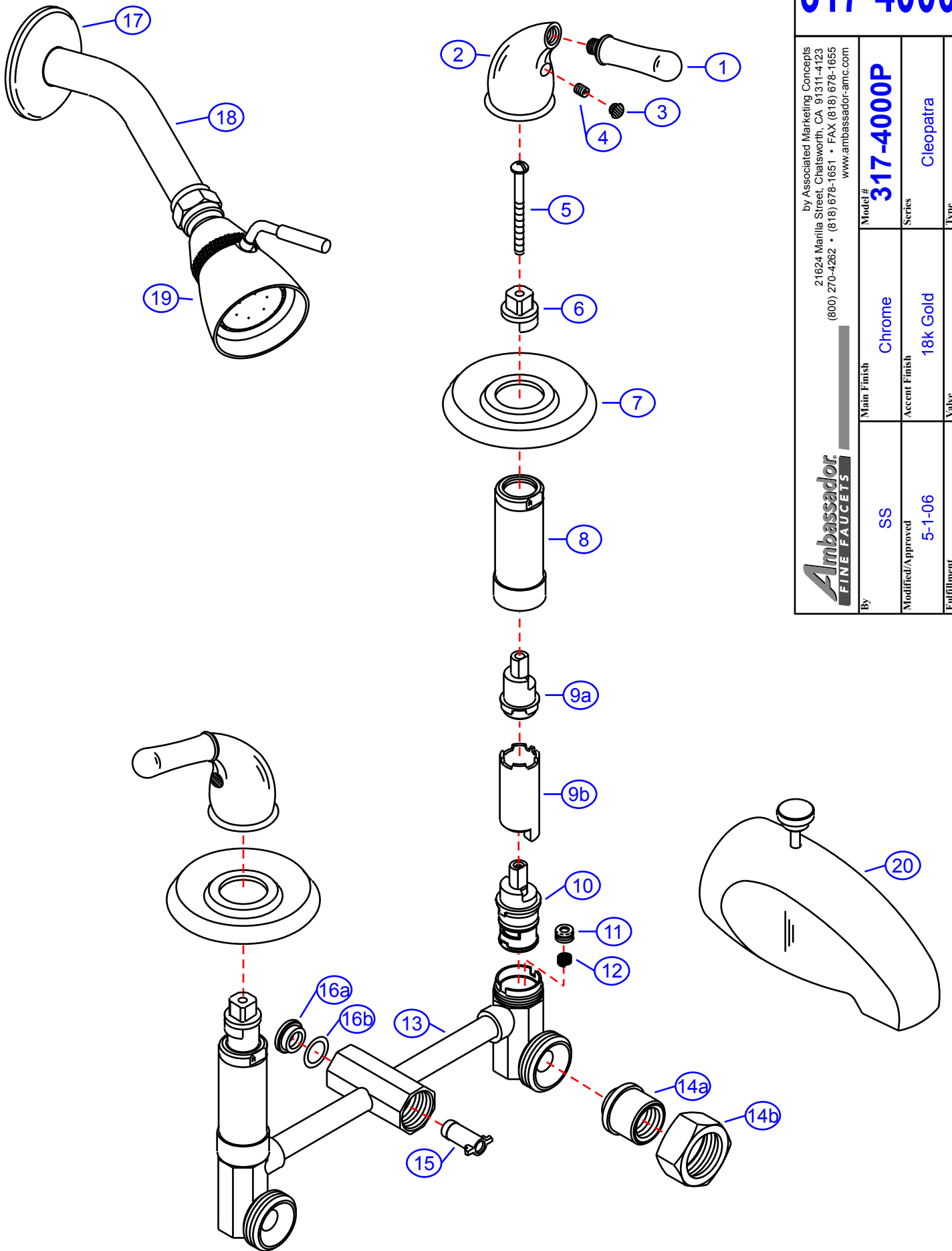

317-4000P



Cleopatra 2 Handle Shower/Tub- Std/CG

#	Description	Quantity	Part #	Finish
1	Handle Tip	2	E-108041GP	Gold
2	Handle Canopy	2	E-018052CP	Chrome
3	Red Plug	1	E-028046H	Rubber
	Blue Plug	1	E-028046C	Rubber
4	Set Screw	2	E-008003	Metal
5	Handle Screw	2	E-008085	Metal
6	Adapter (Hot)	1	E-110114H	Plastic
	Adapter (Cold)	1	E-110114C	Plastic
7	Escutcheon	2	E-111001GP	Gold
8	Retainer Nut	2	E-216000CP	Chrome
9	Stem Extention (Hot)	1	EA-517000H	Plastic
	Stem Extention (Cold)	1	EA-517000C	Plastic
9a	Stem Extention Fitting (Hot)	1	E-110012H*	Plastic
	Stem Extention Fitting (Cold)	1	E-110012C*	Plastic
9b	Stem Extention Body (Hot)	1	E-110007H*	Plastic
	Stem Extention Body (Cold)	1	E-110007C*	Plastic
10	Cartridge	2	E-507006N	Plastic/Brass
11	Seat	2	E-101000N	Rubber
12	Spring	2	E-005000	Metal
13	Valve	1	G-00211-2	Brass
14	Union Nut (Assembled)	2	EA-504100	Brass
14a	Union Sleeve	2	E-009028*	Brass
14b	Union Nut	2	E-009001*	Brass
15	Diverter Spindle	1	E-208022	Plastic
16	Diverter Cap (Assembled)	1	G-A55400	Plastic/Rubber
16a	Diverter Cap	1	E-209000*	Plastic
16b	O-Ring	1	E-004070*	Rubber
17	Shower Arm Escutcheon	1	E-019001GP	Gold
18	Shower Arm	1	E-020002GP	Gold
19	Shower Head	1	E-S11B0200CP	Chrome
20	Tub Spout	1	E-100032GP	Gold

* Grayed parts are not available individually. "Assembled" item required.

by Associated Marketing Concepts
 21624 Marilla Street, Chatsworth, CA 91311-4123
 (800) 270-4262 * (818) 678-1651 * FAX (818) 678-1655
 www.ambassador-amc.com