

317-4000Q

by Associated Marketing Concepts
 21624 Marilla Street, Chatsworth, CA 91311-4123
 (800) 270-4262 • (818) 678-1651 • FAX (818) 678-1655
 www.ambassador-amc.com

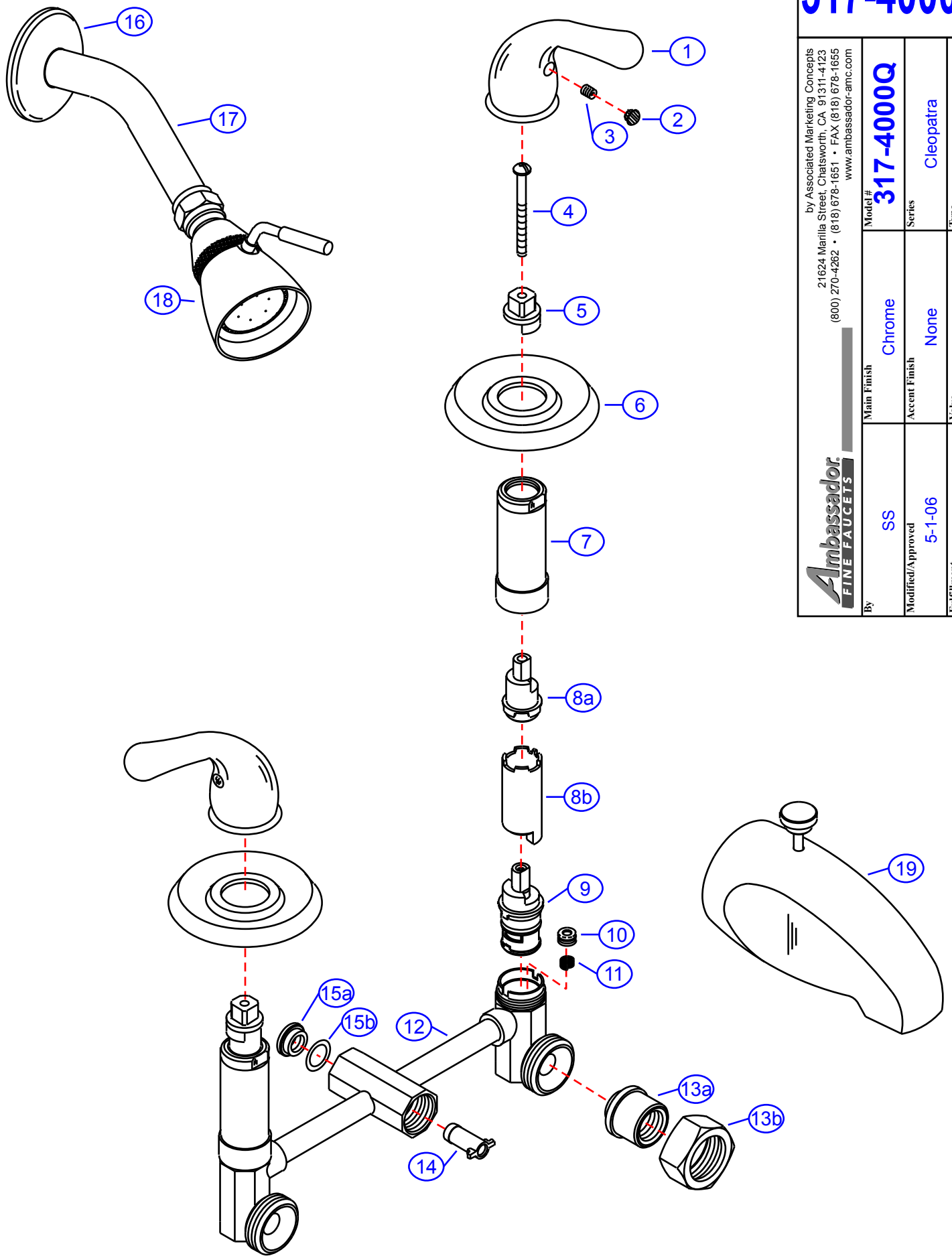

By	SS	Chrome	Model #	317-4000Q
Modified/Approved	5-1-06	None	Series	Cleopatra
Fulfillment	xxxxCP	Standard (Washerless)	Type	2 Handle Shower/Tub



317-4000Q



Cleopatra 2 Handle Shower/Tub- Std/CP

#	Description	Quantity	Part #	Finish
1	Handle	2	E-029032CP	Chrome
2	Red Plug	1	E-028046H	Rubber
	Blue Plug	1	E-028046C	Rubber
3	Set Screw	2	E-008003	Metal
4	Handle Screw	2	E-008085	Metal
5	Adapter (Hot)	1	E-110114H	Plastic
	Adapter (Cold)	1	E-110114C	Plastic
6	Escutcheon	2	E-111001CP	Chrome
7	Retainer Nut	2	E-216000CP	Chrome
8	Stem Extention (Hot)	1	EA-517000H	Plastic
	Stem Extention (Cold)	1	EA-517000C	Plastic
8a	Stem Extention Fitting (Hot)	1	E-110012H*	Plastic
	Stem Extention Fitting (Cold)	1	E-110012C*	Plastic
8b	Stem Extention Body (Hot)	1	E-110007H*	Plastic
	Stem Extention Body (Cold)	1	E-110007C*	Plastic
9	Cartridge	2	E-507006N	Plastic/Brass
10	Seat	2	E-101000N	Rubber
11	Spring	2	E-005000	Metal
12	Valve	1	G-00211-2	Brass
13	Union Nut (Assembled)	2	EA-504100	Brass
13a	Union Sleeve	2	E-009028*	Brass
13b	Union Nut	2	E-009001*	Brass
14	Diverter Spindle	1	E-208022	Plastic
15	Diverter Cap (Assembled)	1	G-A55400	Plastic/Rubber
15a	Diverter Cap	1	E-209000*	Plastic
15b	O-Ring	1	E-004070*	Rubber
16	Shower Arm Escutcheon	1	E-019001CP	Chrome
17	Shower Arm	1	E-020002CP	Chrome
18	Shower Head	1	E-S11B0200CP	Chrome
19	Tub Spout	1	E-100032CP	Chrome

* Grayed parts are not available individually. "Assembled" item required.

by Associated Marketing Concepts
 21624 Marilla Street, Chatsworth, CA 91311-4123
 (800) 270-4262 * (818) 678-1651 * FAX (818) 678-1655
 www.ambassador-amc.com