

106-G

by Associated Marketing Concepts
 21624 Marilla Street, Chatsworth, CA 91311-4123
 (800) 270-4262 • (818) 678-1651 • FAX (818) 678-1655
 www.ambassador-amc.com

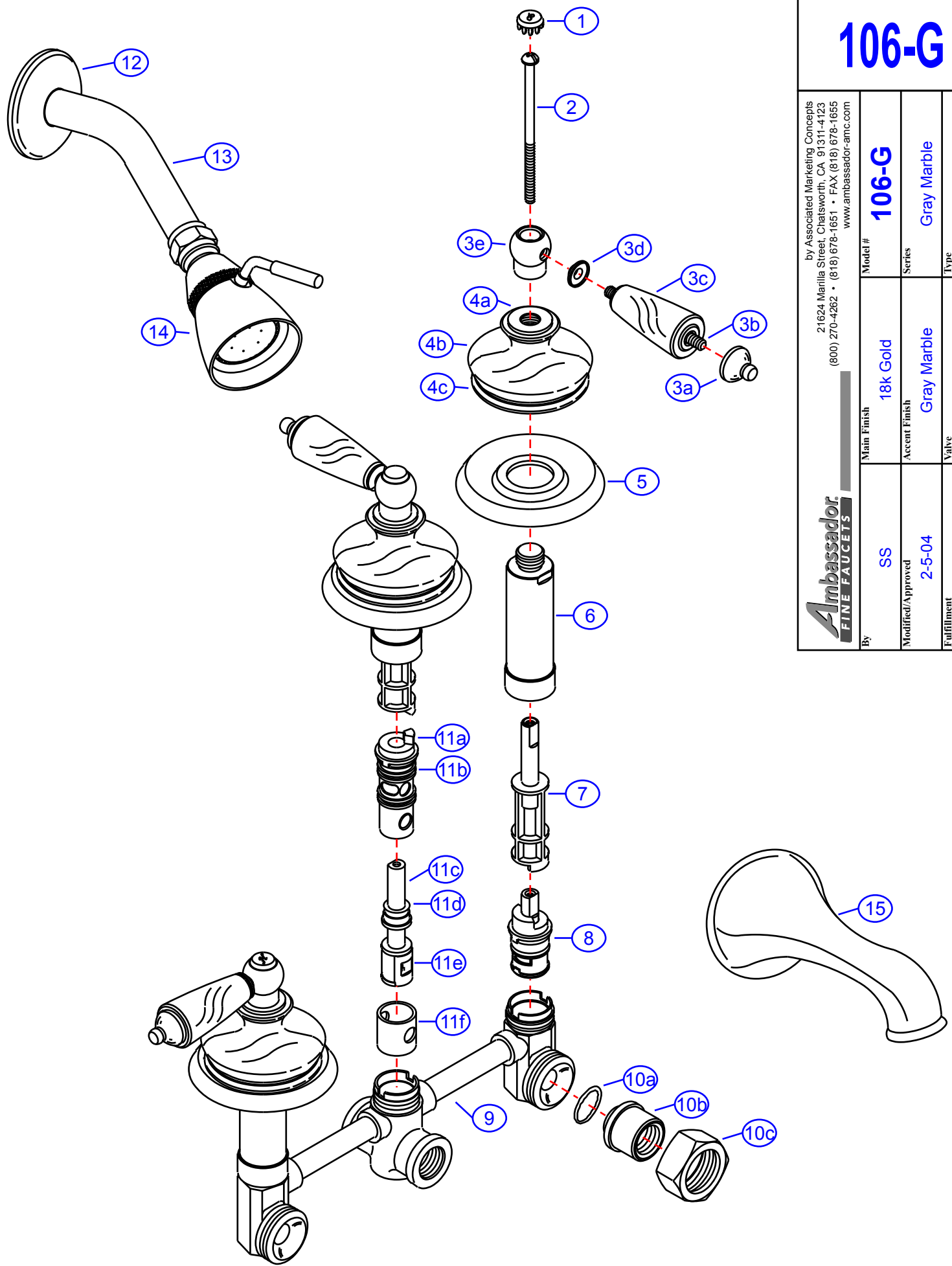

| | | | | |
|-------------------|------------|--------------|---------|---------------------|
| By | SS | 18k Gold | Model # | 106-G |
| Modified/Approved | 2-5-04 | Gray Marble | Series | Gray Marble |
| Fulfillment | F30A7700GW | Ceramic Disk | Type | 3 Handle Shower/Tub |



106-G



Gray Marble 3 Handle Shower/Tub- CD/GP

| # | Description | Quantity | Part # | Finish |
|-----|----------------------------|----------|--------------|---------------|
| 1 | Cap "H" | 1 | E-206041HGP | Gold |
| | Cap "C" | 1 | E-206041CGP | Gold |
| | Cap "Blank" | 1 | E-206041GP | Gold |
| 2 | Handle Screw | 3 | E-008019 | Metal |
| 3 | Marble Widespread Handle | 3 | G-A90132GP | Gold/Marble |
| 3a | Handle Tip | 3 | E-109003GP | Gold |
| 3b | Handle Rod | 3 | E-017045 | Metal |
| 3c | Handle (Marble) | 3 | E-108027 | Marble |
| 3d | Handle Spacer | 3 | E-107034GP | Gold |
| 3e | Handle Head | 3 | E-226002GP | Gold |
| 4 | Canopy (Assembled) | 3 | EA-667338CP | Gold/Marble |
| 4a | Canopy Threads | 3 | E-205007GP* | Gold |
| 4b | Canopy | 3 | E-018023* | Gray Marble |
| 4c | Canopy Base | 3 | E-215010GP* | Gold |
| 5 | Escutcheon | 3 | E-111001GP | Gold |
| 6 | Retainer Nut | 3 | E-216002GP | Gold |
| 7 | Stem Extension (Hot) | 2 | E-110009H | Plastic/Brass |
| | Stem Extension (Cold) | 1 | E-110009C | Plastic/Brass |
| 8 | Cartridge (Hot) | 1 | E-507003NH | Ceramic Disc |
| | Cartridge (Cold) | 1 | E-507003NC | Ceramic Disc |
| 9 | Valve Body | 1 | E-002067 | Brass |
| 10 | Union Nut (Assembled) | 2 | EA-504100 | Brass |
| 10a | O-Ring | 2 | E-004064 | Rubber |
| 10b | Union Sleeve | 2 | E-009028* | Brass |
| 10c | Union Nut | 2 | E-009001* | Brass |
| 11 | Diverter Cartridge | 1 | EA-501016 | Plastic |
| 11a | Diverter Cartridge Housing | 1 | E-214008* | Plastic |
| 11b | O-Ring | 1 | E-004037* | Rubber |
| 11c | Diverter Cartridge Body | 1 | E-208023* | Plastic |
| 11d | O-Ring | 1 | E-004011* | Rubber |
| 11e | Diverter Cartridge Stopper | 1 | E-010047* | Plastic |
| 11f | Diverter Cartridge Boot | 1 | E-010015* | Rubber |
| 12 | Shower Arm Escutcheon | 1 | E-019001GP | Gold |
| 13 | Shower Arm | 1 | E-020002GP | Gold |
| 14 | Shower Head | 1 | E-S11B0200GP | Gold |
| 15 | Tub Spout | 1 | E-100014GP | Gold |

* Grayed parts are not available individually. "Assembled" item required.

by Associated Marketing Concepts
21624 Marilla Street, Chatsworth, CA 91311-4123
(800) 270-4262 * (818) 678-1651 * FAX (818) 678-1655
www.ambassador-amc.com