

# 317-4001P

by Associated Marketing Concepts  
 21624 Marilla Street, Chatsworth, CA 91311-4123  
 (800) 270-4262 • (818) 678-1651 • FAX (818) 678-1655  
 www.ambassador-amc.com

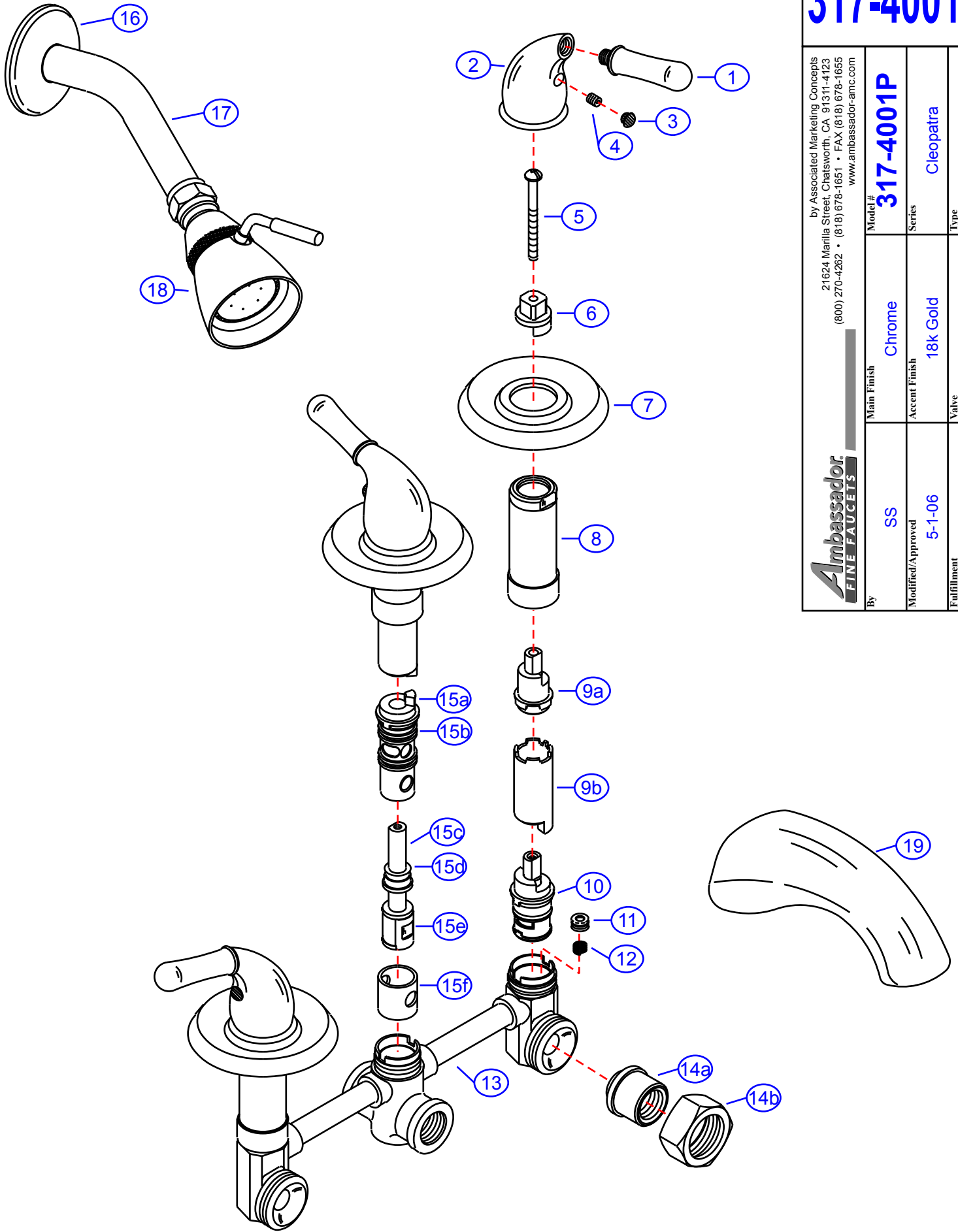

|                   |        |                       |                     |
|-------------------|--------|-----------------------|---------------------|
| By                | SS     | Chrome                | Model #             |
| Modified/Approved | 5-1-06 | 18k Gold              | <b>317-4001P</b>    |
| Fulfillment       | xxxCG  | Standard (Washerless) | Series              |
|                   |        |                       | Cleopatra           |
|                   |        |                       | Type                |
|                   |        |                       | 3 Handle Shower/Tub |



# 317-4001P



## Cleopatra 3 Handle Shower/Tub- Std/CG

| #   | Description                   | Quantity | Part #       | Finish        |
|-----|-------------------------------|----------|--------------|---------------|
| 1   | Handle Tip                    | 3        | E-108041GP   | Gold          |
| 2   | Handle Canopy                 | 3        | E-018052CP   | Chrome        |
| 3   | Red Plug                      | 1        | E-028046H    | Rubber        |
|     | Blue Plug                     | 1        | E-028046C    | Rubber        |
|     | Black Plug                    | 1        | E-028046M    | Rubber        |
| 4   | Set Screw                     | 3        | E-008003     | Metal         |
| 5   | Handle Screw                  | 3        | E-008085     | Metal         |
| 6   | Adapter (Hot)                 | 2        | E-110114H    | Plastic       |
|     | Adapter (Cold)                | 1        | E-110114C    | Plastic       |
| 7   | Escutcheon                    | 3        | E-111001GP   | Gold          |
| 8   | Retainer Nut                  | 3        | E-216000CP   | Chrome        |
| 9   | Stem Extension (Hot)          | 2        | EA-517000H   | Plastic       |
|     | Stem Extension (Cold)         | 1        | EA-517000C   | Plastic       |
| 9a  | Stem Extension Fitting (Hot)  | 2        | E-110012H*   | Plastic       |
|     | Stem Extension Fitting (Cold) | 1        | E-110012C*   | Plastic       |
| 9b  | Stem Extension Body (Hot)     | 2        | E-110007H*   | Plastic       |
|     | Stem Extension Body (Cold)    | 1        | E-110007C*   | Plastic       |
| 10  | Cartridge                     | 2        | E-507006N    | Plastic/Brass |
| 11  | Seat                          | 2        | E-101000N    | Rubber        |
| 12  | Spring                        | 2        | E-005000     | Metal         |
| 13  | Valve                         | 1        | E-002015     | Brass         |
| 14  | Union Nut (Assembled)         | 2        | EA-504100    | Brass         |
| 14a | Union Sleeve                  | 2        | E-009028*    | Brass         |
| 14b | Union Nut                     | 2        | E-009001*    | Brass         |
| 15  | Diverter Cartridge            | 1        | EA-501016    | Plastic       |
| 15a | Diverter Cartridge Housing    | 1        | E-214008*    | Plastic       |
| 15b | O-Ring                        | 1        | E-004037*    | Rubber        |
| 15c | Diverter Cartridge Body       | 1        | E-208023*    | Plastic       |
| 15d | O-Ring                        | 1        | E-004011*    | Rubber        |
| 15e | Diverter Cartridge Stopper    | 1        | E-010047*    | Plastic       |
| 15f | Diverter Cartridge Boot       | 1        | E-010015*    | Rubber        |
| 16  | Shower Arm Escutcheon         | 1        | E-019001GP   | Gold          |
| 17  | Shower Arm                    | 1        | E-020002GP   | Gold          |
| 18  | Shower Head                   | 1        | E-S11B0200CP | Chrome        |
| 19  | Tub Spout                     | 1        | E-100015GP   | Gold          |

\* Grayed parts are not available individually. "Assembled" item required.

by Associated Marketing Concepts  
 21624 Marilla Street, Chatsworth, CA 91311-4123  
 (800) 270-4262 \* (818) 678-1651 \* FAX (818) 678-1655  
[www.ambassador-amc.com](http://www.ambassador-amc.com)