

317-4001Q

by Associated Marketing Concepts
 21624 Marilla Street, Chatsworth, CA 91311-4123
 (800) 270-4262 • (818) 678-1651 • FAX (818) 678-1655
 www.ambassador-amc.com

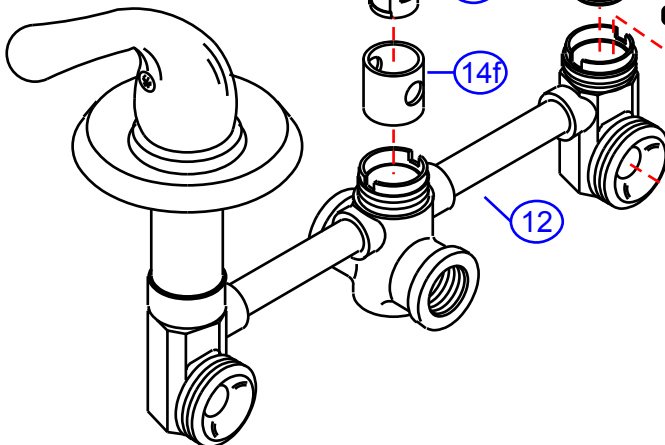

By	SS	Main Finish	Chrome	Model #	317-4001Q
Modified/Approved	5-1-06	Accent Finish	None	Series	Cleopatra
Fulfillment	xxxCP	Valve	Standard (Washerless)	Type	3 Handle Shower/Tub

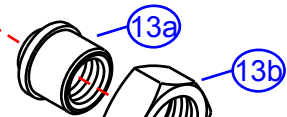
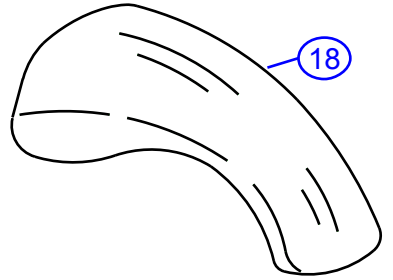
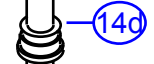
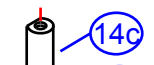
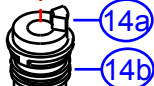
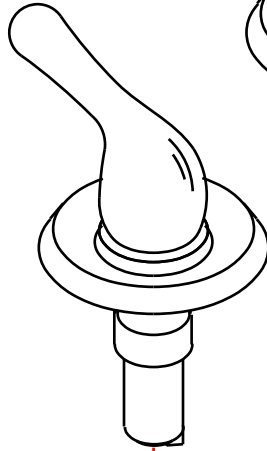
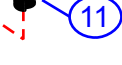
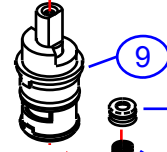
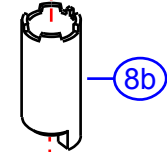
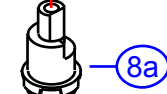
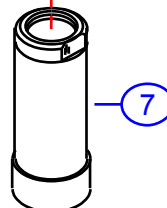
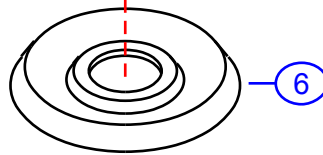
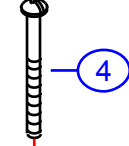
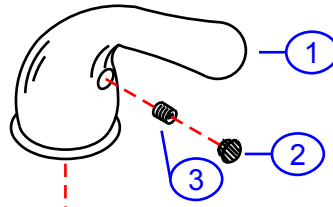
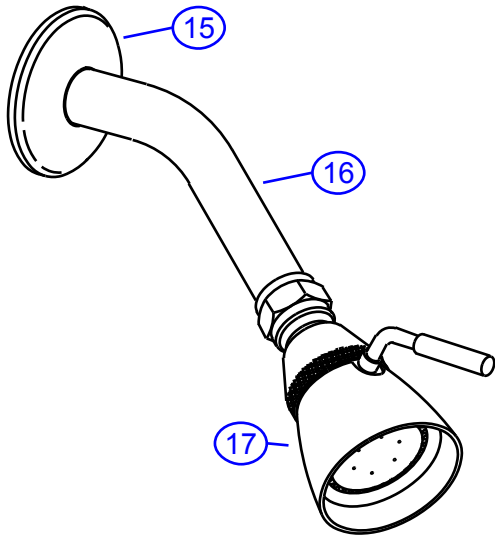

317-4001Q



Cleopatra 3 Handle Shower/Tub- Std/CP

#	Description	Quantity	Part #	Finish
1	Handle	3	E-029032CP	Chrome
2	Red Plug	1	E-028046H	Rubber
	Blue Plug	1	E-028046C	Rubber
	Black Plug	1	E-028046M	Rubber
3	Set Screw	3	E-008003	Metal
4	Handle Screw	3	E-008085	Metal
5	Adapter (Hot)	2	E-110114H	Plastic
	Adapter (Cold)	1	E-110114C	Plastic
6	Escutcheon	3	E-111001CP	Chrome
7	Retainer Nut	3	E-216000CP	Chrome
8	Stem Extention (Hot)	2	EA-517000H	Plastic
	Stem Extention (Cold)	1	EA-517000C	Plastic
8a	Stem Extention Fitting (Hot)	2	E-110012H*	Plastic
	Stem Extention Fitting (Cold)	1	E-110012C*	Plastic
8b	Stem Extention Body (Hot)	2	E-110007H*	Plastic
	Stem Extention Body (Cold)	1	E-110007C*	Plastic
9	Cartridge	2	E-507006N	Plastic/Brass
10	Seat	2	E-101000N	Rubber
11	Spring	2	E-005000	Metal
12	Valve	1	E-002015	Brass
13	Union Nut (Assembled)	2	EA-504100	Brass
13a	Union Sleeve	2	E-009028*	Brass
13b	Union Nut	2	E-009001*	Brass
14	Diverter Cartridge	1	EA-501016	Plastic
14a	Diverter Cartridge Housing	1	E-214008*	Plastic
14b	O-Ring	1	E-004037*	Rubber
14c	Diverter Cartridge Body	1	E-208023*	Plastic
14d	O-Ring	1	E-004011*	Rubber
14e	Diverter Cartridge Stopper	1	E-010047*	Plastic
14f	Diverter Cartridge Boot	1	E-010015*	Rubber
15	Shower Arm Escutcheon	1	E-019001CP	Chrome
16	Shower Arm	1	E-020002CP	Chrome
17	Shower Head	1	E-S11B0200CP	Chrome
18	Tub Spout	1	E-100015CP	Chrome

* Grayed parts are not available individually. "Assembled" item required.

by Associated Marketing Concepts
 21624 Marilla Street, Chatsworth, CA 91311-4123
 (800) 270-4262 * (818) 678-1651 * FAX (818) 678-1655
www.ambassador-amc.com