

# 406-P

by Associated Marketing Concepts  
 21624 Marilla Street, Chatsworth, CA 91311-4123  
 (800) 270-4262 | (818) 678-1651 | FAX (818) 678-1655  
 www.ambassador-amc.com

**Ambassador**  
 FINE FAUCETS

By	SS	Main Finish	Chrome	Model #	406-P
Modified/Approved	2-16-04	Accent Finish	18k Gold	Series	Cleopatra
Fulfillment	F30A5703CG	Valve	Ceramic Disk	Type	3 Handle Shower/Tub

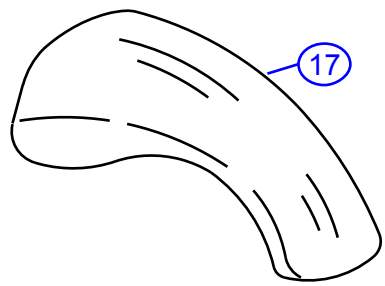
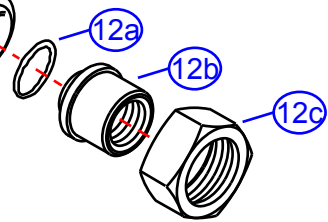
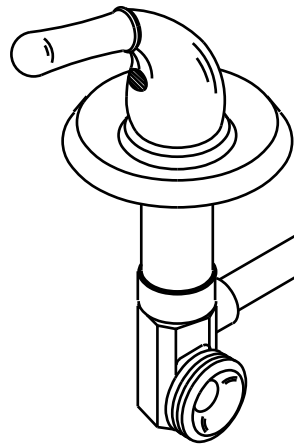
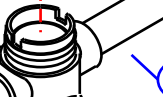
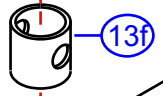
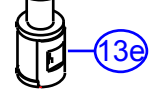
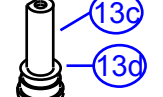
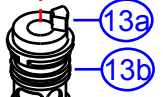
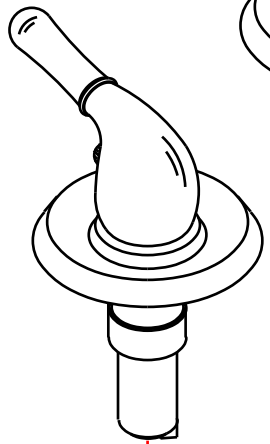
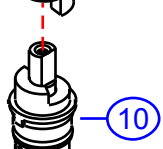
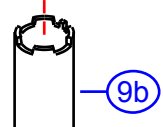
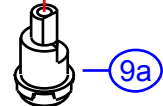
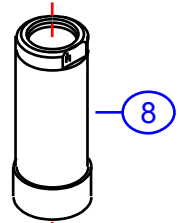
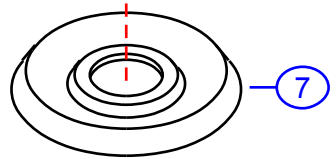
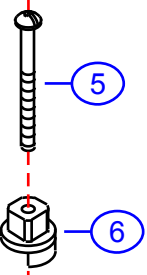
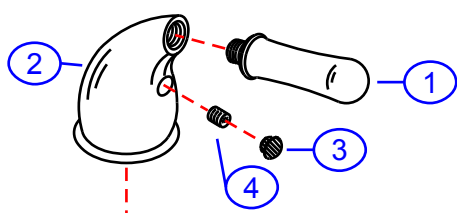
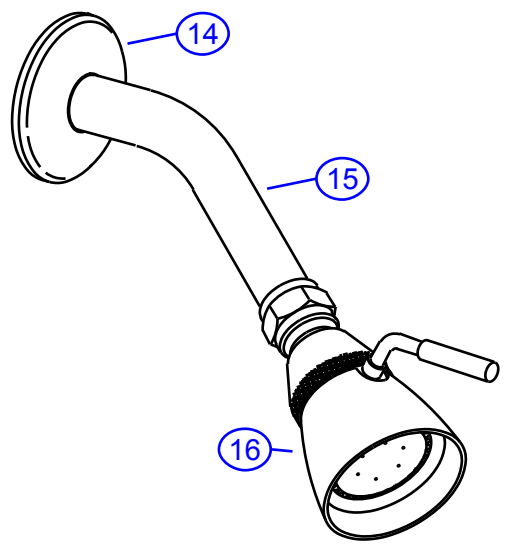

# 406-P



## Cleopatra 3 Handle Shower/Tub- CD/CG

#	Description	Quantity	Part #	Finish
1	Handle Tip	3	E-108041GP	Gold
2	Handle Canopy	3	E-018052CP	Chrome
3	Red Plug	1	E-028046H	Rubber
	Blue Plug	1	E-028046C	Rubber
	Black Plug	1	E-028046M	Rubber
4	Set Screw	3	E-008003	Metal
5	Handle Screw	3	E-008085	Metal
6	Adapter (Hot)	2	E-110114H	Plastic
	Adapter (Cold)	1	E-110114C	Plastic
7	Escutcheon	3	E-111001GP	Gold
8	Retainer Nut	3	E-216000CP	Chrome
9	Stem Extension (Hot)	2	EA-517000H	Plastic
	Stem Extension (Cold)	1	EA-517000C	Plastic
9a	Stem Extension Fitting (Hot)	2	E-110012H*	Plastic
	Stem Extension Fitting (Cold)	1	E-110012C*	Plastic
9b	Stem Extension Body (Hot)	2	E-110007H*	Plastic
	Stem Extension Body (Cold)	1	E-110007C*	Plastic
10	Cartridge (Hot)	1	E-507003NH	Ceramic Disc
	Cartridge (Cold)	1	E-507003NC	Ceramic Disc
11	Valve	1	E-002067	Brass
12	Union Nut (Assembled)	2	EA-504100	Brass
12a	O-Ring	2	E-004064	Brass
12b	Union Sleeve	2	E-009028*	Brass
12c	Union Nut	2	E-009001*	Brass
13	Diverter Cartridge	1	EA-501016	Plastic
13a	Diverter Cartridge Housing	1	E-214008*	Plastic
13b	O-Ring	1	E-004037*	Rubber
13c	Diverter Cartridge Body	1	E-208023*	Plastic
13d	O-Ring	1	E-004011*	Rubber
13e	Diverter Cartridge Stopper	1	E-010047*	Plastic
13f	Diverter Cartridge Boot	1	E-010015*	Rubber
14	Shower Arm Escutcheon	1	E-019001GP	Gold
15	Shower Arm	1	E-020002GP	Gold
16	Shower Head	1	E-S11B0200CP	Chrome
17	Tub Spout	1	E-100015GP	Gold

\* Grayed parts are not available individually. "Assembled" item required.

by Associated Marketing Concepts  
 21624 Marilla Street, Chatsworth, CA 91311-4123  
 (800) 270-4262 \* (818) 678-1651 \* FAX (818) 678-1655  
[www.ambassador-amc.com](http://www.ambassador-amc.com)