

# 317-1396

by Associated Marketing Concepts  
21624 Marilla Street, Chatsworth, CA 91311-4123  
(800) 270-4262 | (818) 678-1651 | FAX (818) 678-1655  
www.ambassador-amc.com

**Ambassador**  
FINE FAUCETS

By	SS	Main Finish	Chrome	Model #	<b>317-1396</b>
Modified/Approved	4-5-04	Accent Finish	Dura-Life Finish	Series	Mirage + Curved Arm
Fulfillment	S110501CY	Valve	NA	Type	Shower Head

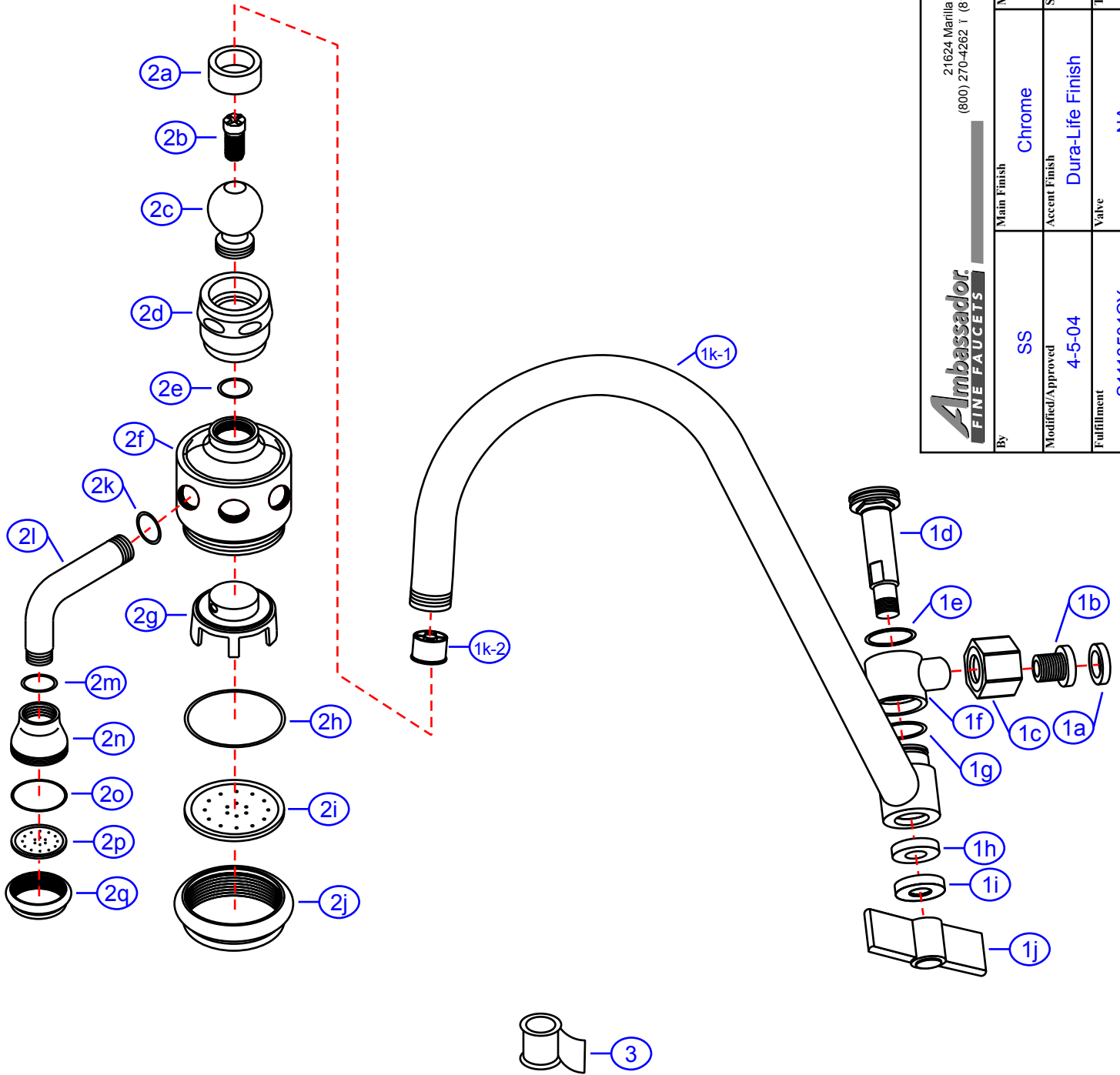

# 317-1396



## Mirage + Curved Arm- CY

#	Description	Quantity	Part #	Finish
1	Curved Arm (Assembled)	1	8015-Y	Chrome/Dura-Life Finish
1a	Washer	1	E-060080	Rubber
1b	Coupler	1	E-077049	Brass
1c	Union Nut	1	E-077051CP	Chrome
1d	Bolt	1	E-125034CP	Chrome
1e	O-Ring	1	E-048091	Rubber
1f	Connector	1	E-077052CP	Chrome
1g	O-Ring	1	E-004015	Rubber
1h	Washer	1	E-058022	Rubber
1i	Cap	1	E-045008CP	Chrome
1j	Wing Nut	1	E-029087YP	Dura-Life Finish
1k	Adjustable Arm (Assembled)	1	G-A90350CP	Chrome
1k-1	Curved Arm	1	E-020071CP*	Chrome
1k-2	Insert	1	E-112143	Plastic
2	Mirage Showerhead (Assembled)	1	8115-Y	Chrome/Dura-Life Finish
2a	Gasket	1	E-058042	Rubber
2b	Water Restrictor	1	E-075011	Metal
2c	Ball Joint	1	E-077045CP*	Chrome
2d	Housing	1	E-077047CP*	Chrome
2e	O-Ring	1	E-048084	Rubber
2f	Body	1	E-076015CP*	Chrome
2g	Diverter	1	E-209022	Plastic
2h	O-Ring	1	E-063087	Rubber
2i	Center Disc	1	E-112258CP	Chrome
2j	Center Collar	1	E-045037YP	Dura-Life Finish
2k	O-Ring	6	E-072058*	Rubber
2l	Arm	6	E-020072CP*	Chrome
2m	O-Ring	6	E-072058*	Rubber
2n	Bonnet	6	E-077046CP*	Chrome
2o	O-Ring	6	E-004010	Rubber
2p	Disc	6	E-112260CP	Chrome
2q	Collar	6	E-033041YP	Dura-Life Finish
3	Teflon Tape	1	E-203000	Tape

\* Grayed parts are not available individually. "Assembled" item required.